

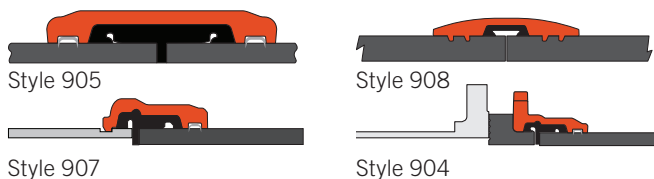

## System Solution for HDPE Pipe

Strong, durable, and easy to install, the Victaulic® system solution for high-density polyethylene (HDPE) offers a complete line of Installation-Ready™ plain end and grooved products. Installation is up to ten times faster than fusion, weather agnostic, and requires only simple tools. *Victaulic* couplings for HDPE can be buried or submerged, offer pressure ratings that meet or exceed pressure ratings of HDPE pipe, and offer visual verification of proper joint assembly.

[Download publication 02.06](#) for ANSI/NSF Potable Water Approvals/Listings



To learn more visit [victaulic.com/hdpesolutions](http://victaulic.com/hdpesolutions)

<b>Couplings</b>	<b>page</b>	<b>Fittings</b>	<b>page</b>
Coupling for Plain End HDPE Pipe (Style 905)	106	Plain End HDPE Fittings	107
Transition Coupling for HDPE-to-Steel Pipe (Style 907 and Style W907)	106	<b>Valve</b>	<b>page</b>
Coupling for Double Grooved HDPE Pipe (Style 908)	106	Knife Gate Valve for HDPE Pipe (Series 906)	107
Transition Coupling for HDPE to Shouldered Steel (Style SC998)	80	<b>Outlets</b>	<b>page</b>
Aquamine™ Transition Coupling for PVC to HDPE (Series 2971)	111	<i>Mechanical-T</i> Bolted Branch Outlet and Cross Assemblies (Style 920/920N)	46
<b>Adapter</b>	<b>page</b>	Stainless Steel <i>Mechanical-T</i> Bolted Branch Outlet (Style 422)	60
Flange Adapter for HDPE-to-Flanged Pipe (Style 904)	107	<i>Mechanical-T</i> Spigot Outlet (Style 926)	47
		<b>Pipe Preparation Tool</b>	<b>page</b>
		Cut Grooving Tool for HDPE Pipe	136



**Certifications/Listings:**



[Download publication 10.01](#) for Fire Protection Certifications/Listings

[Download publication 02.06](#) for ANSI/NSF Potable Water Approvals/Listings

## Coupling for Plain End HDPE Pipe

STYLE 905

[Download publication 19.07](#) for complete information

- Designed for plain end HDPE pipe (SDR 7–SDR 21)
- Sizes from 2–14" IPS and 63–355mm ISO
- Pressure rating meets or exceeds the performance capabilities of the pipe



**Certifications/Listings:**



[Download publication 10.01](#) for Fire Protection Certifications/Listings

[Download publication 02.06](#) for ANSI/NSF Potable Water Approvals/Listings

## Transition Coupling for HDPE-to-Steel Pipe

STYLE 907 and STYLE W907

[Download publication 19.10](#) for complete information

- Designed to provide a single transition from plain end HDPE pipe (SDR 7–SDR 21) to grooved steel sized piping system components
- Sizes from 2–14" IPS HDPE to 2–14" | DN50–DN350 IPS grooved steel
- Sizes from 63–355 mm ISO HDPE to 2–14" | DN50–DN350 ISO grooved steel
- Pressure rating meets or exceeds the performance capability of the pipe

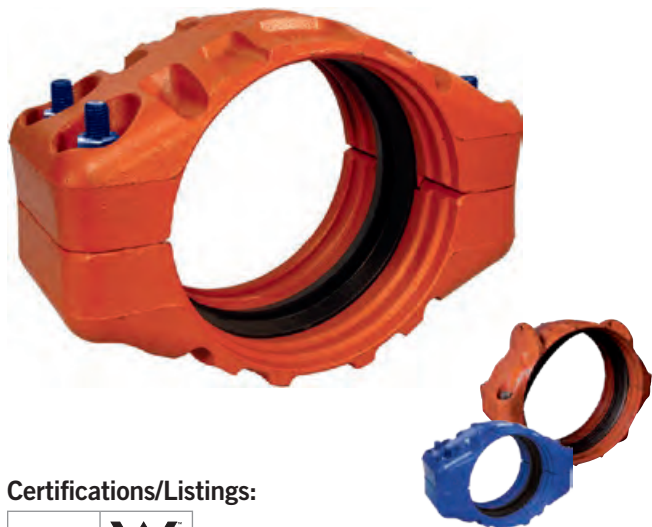

**Certifications/Listings:**



[Download publication 10.01](#) for Fire Protection Certifications/Listings

[Download publication 02.06](#) for ANSI/NSF Potable Water Approvals/Listings

## Coupling for Double Grooved HDPE Pipe

STYLE 908

[Download publication 19.09](#) for complete information

- Designed for double-grooved HDPE (SDR 7–SDR 21)
- Sizes from 8–36" IPS and 250–900 mm ISO
- Standard Victaulic® coupling assembly procedure used for installation

## System Solution for HDPE Pipe

INSTALLATION-  
READY™Flange Adapter for  
HDPE-to-Flanged Pipe

STYLE 904

[Download publication 19.12](#) for complete information

- Designed to provide a single transition from plain end HDPE pipe (SDR 7–SDR 21) to flanged piping system components
- Sizes from 3–8" IPS HDPE to 3–8" IPS ANSI Class 150 Flange
- Regional availability, contact [Victaulic](#) for details



## Plain End HDPE Fittings

[Download publication 19.11](#) for complete information

- Available in SDR 7, SDR 9, SDR 11, and SDR 17
- Sizes from 2–8" IPS and 63–225mm ISO
- Full flow fittings
- For use with Style 905, Style 907, and Style 904

No. H10  
90° ElbowNo. H11  
45° ElbowNo. H20  
TeeNo. H50  
ReducerINSTALLATION-  
READY™

## Knife Gate Valve for HDPE Pipe

SERIES 906

[Download publication 19.06](#) for complete information

- Designed for HDPE (SDR 7–SDR 21) fluid lines containing solids, slurry, and/or abrasive media
- All wear parts can be replaced in-line without removing the valve from the pipeline
- Manual, hydraulic, pneumatic, and electric actuation available
- Sizes from 3–8"
- Pressures up to 150psi | 1035 kPa | 10bar
- Regional availability, contact [Victaulic](#) for details













## Aquamine™ PVC System

Victaulic® Aquamine™ reusable PVC piping system offers a complete line of reusable pipe, fittings, valves and specialty items. This product line is ideal for a wide variety of water and chemical services due to the high-impact resistance of *Aquamine* PVC pipe and synthetic rubber O-rings. The spline assembly used in *Victaulic Aquamine* PVC piping uniquely engages into the grooves of both the coupling and the pipe.

[Download publication 02.06](#) for ANSI/NSF Potable Water Approvals/Listings



<b>Pipe</b>	<b>page</b>	<b>Fittings</b>	<b>page</b>
 <i>Aquamine</i> Pipe (Series 2900)	110	 <i>Aquamine</i> Fittings	112
<b>Couplings</b>	<b>page</b>	<b>Valves</b>	<b>page</b>
 <i>Aquamine</i> Couplings	110	 <i>Aquamine</i> Ball Valve (Series 2921)	113
Female to Female (Series 2904)		 <i>Aquamine</i> Butterfly Valve (Series 2950)	113
Female to Female Beveled			
Female to Solvent Cement Female (Series 2905)			
Female to Female with Female NPT Outlet (Series 2930)			
Female to Female with Female NPT Formed Outlet (Series 2937, 2938, 2939)			
 <i>Aquamine</i> Coupling for Plain End PVC (Series 2970)	111	<b>Pipe Preparation Tool</b>	<b>page</b>
 <i>Aquamine</i> Transition Coupling for PVC to HDPE (Series 2971)	111	 <i>Aquamine</i> Grooving Tool	136
 <i>Aquamine</i> Transition Coupling for PVC to Groove (Series 2972)	111		

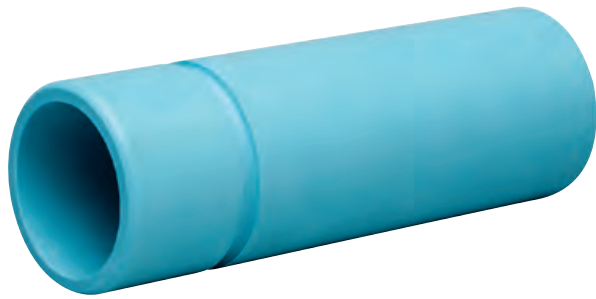

## Aquamine™ PVC Pipe

SERIES 2900

[Download publication 50.01](#) for complete information

- PVC 1120 Type 1, Grade 1 (Class 12454) conforming to ASTM D-1784 and ASTM D-2241
- Sizes from 2–12" | DN50–DN300
- Pressures up to 350 psi | 2413 kPa | 24 bar

### Certifications/Listings:



[Download publication 02.06](#) for ANSI/NSF Potable Water Approvals/Listings



## Aquamine™ Couplings

[Download publication 50.01](#) for complete information

- Sizes from 2–12" | DN50–DN300
- Pressures up to 350 psi | 2413 kPa | 24 bar

### Certifications/Listings:



[Download publication 02.06](#) for ANSI/NSF Potable Water Approvals/Listings



**Series 2904**  
Female to Female



**Female to Female Beveled**



**Series 2937** (1" | 25 mm Outlet)  
**Series 2938** (1½" | 38 mm Outlet)  
**Series 2939** (2" | 50 mm Outlet)  
Female to Female with Female NPT Formed Outlet



**Series 2905**  
Female to Solvent Cement Female



**Series 2930**  
Female to Female with Female NPT Outlet

## Aquamine™ PVC System



### Aquamine™ Coupling for Plain End PVC

SERIES 2970

[Download publication 50.01](#) for complete information

- Coupling for plain end PVC systems; no pipe preparation required
- Sizes from 2–8" | DN50–DN200
- Pressures up to 350 psi | 2413 kPa | 24 bar



### Aquamine™ Transition Coupling for PVC to HDPE

SERIES 2971

[Download publication 50.05](#) for complete information

- Provides convenient transition from PVC to HDPE without need for special adapters
- Sizes from 2–8" | DN50–DN200
- Pressures up to 350 psi | 2413 kPa | 24 bar



### Aquamine™ Transition Coupling for PVC to Groove

SERIES 2972

[Download publication 50.06](#) for complete information

- Provides convenient transition from PVC to grooved steel without need for special adapters
- Sizes from 2–8" | DN50–DN200
- Pressures up to 350 psi | 2413 kPa | 24 bar



## Aquamine™ Fittings

[Download publication 50.01](#) for complete information

- Variety of straight and reducing fittings
- Sizes from 2–12" | DN50–DN300
- Pressures up to 350 psi | 2413 kPa | 24 bar

### Certifications/Listings:



[Download publication 02.06](#) for ANSI/NSF Potable Water Approvals/Listings



**Series 2906**  
Male x Plain End  
Male Adapter  
Nipple

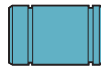

**Series 2907**  
Male x Victaulic®  
OGS Groove  
Adapter Nipple



**Series 2908**  
Male x Male NPT  
Adapter Nipple



**Series 2909**  
Plain End Male x  
Male NPT  
Adapter Nipple

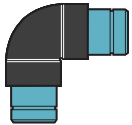

**Series 2910**  
Male x Male  
90° Elbow



**Series 2911**  
Male x Male  
22½° Elbow



**Series 29102**  
Male x Male  
11¼° Elbow

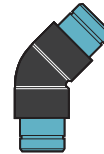

**Series 2912**  
Male x Male  
45° Long

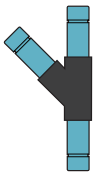

**Aqua Link**  
Male x Male x Male  
Lateral Wye

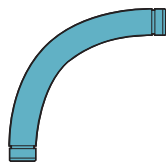

**Series 2913**  
Male x Male  
90° Sweep



**Series 2914**  
Male x Male  
45° Sweep

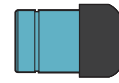

**Series 2915**  
Male  
End Cap

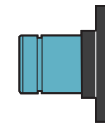

**Series 2916**  
Male x Flanged  
Adapter Nipple

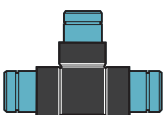

**Series 2917**  
Male x Male x Male  
Tee

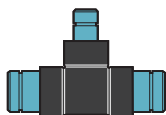

**Series 2918**  
Male x Male x Male  
Reducing Tee

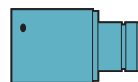

**Series 2919**  
Female x Male  
Reducer



**Series 2920**  
Male x Solvent  
Cement Female  
Transition



**Series 2940**  
Female x Male  
Transition with  
Female NPT Outlet



## Aquamine™ PVC System



### Aquamine™ Ball Valve

SERIES 2921

[Download publication 50.01](#) for complete information

- Available with a lever handle or a square nut
- Sizes from 2–6" | DN50–DN150
- Pressures up to 100 psi | 690 kPa | 7 bar



### Aquamine™ Butterfly Valve

SERIES 2950

[Download publication 50.01](#) for complete information

- Provided with a lever handle for easy on-off operation
- Sizes from 2–6" | DN50–DN150
- Pressures up to 250 psi | 1724 kPa | 17 bar



## CPVC/PVC System

Victaulic now offers the industry's first and only grooved piping system designed exclusively for use on Schedules 40 and 80 chlorinated polyvinyl chloride/polyvinyl chloride (CPVC/PVC) pipe featuring Victaulic's proprietary PGS-300 groove profile. Available in sizes 2–12" | DN50–DN300, the system includes a full line of Installation-Ready™ couplings, fittings and pipe preparation tools. This system solution offers the fastest, cleanest installation method for CPVC/PVC pipe and eliminates several drawbacks associated with traditional joining methods.

[Download publication 02.06](#) for ANSI/NSF Potable Water Approvals/Listings

### PGS™-300

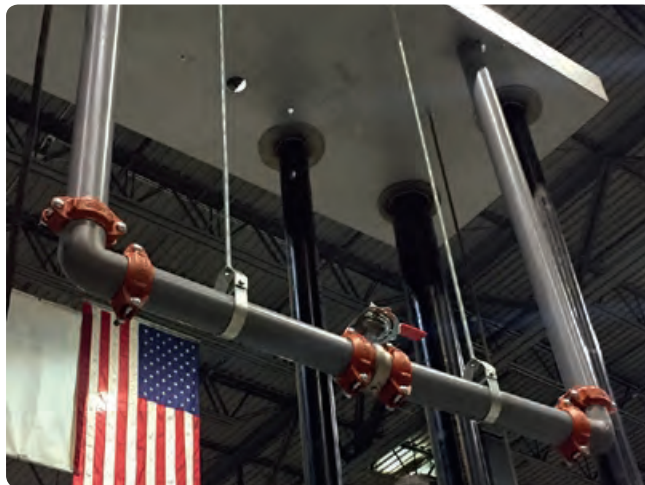

To learn more visit [victaulic.com/cpvc/solutions](http://victaulic.com/cpvc/solutions)

Couplings		page	Fittings		page
	Installation-Ready Rigid Coupling (Style 357)	116		PGS-300 Grooved End Fittings	117
	Installation-Ready Transition Coupling (Style 356)	116	<b>Expansion Joint</b>		
	Reducing Coupling (Style 358)	116		PGS-300 Grooved End Expansion Joint (Style 355)	118
			<b>Pipe Preparation Tool</b>		<b>page</b>
				Cut Grooving Tool for Plastic Pipe (CG1100)	135

INSTALLATION-READY™



## Installation-Ready™ Rigid Coupling STYLE 357

[Download publication 33.07](#) for complete information

- Exclusively for use on CPVC/PVC pipe featuring Victaulic's proprietary PGS-300 groove profile
- Sizes from 2–12" | DN50–DN300
- Refer to the publication for maximum pressure ratings and temperature reduction factors
- Regional availability, contact [Victaulic](#) for details

### Certifications/Listings:



[Download publication 02.06](#) for ANSI/NSF Potable Water Approvals/Listings

INSTALLATION-READY™



## Installation-Ready™ Transition Coupling STYLE 356

[Download publication 33.06](#) for complete information

- Provides a direct, single coupling connection for Victaulic® PGS-300 grooved end CPVC/PVC pipe or fittings to *Victaulic* Original Groove System (OGS) grooved end IPS or stainless steel pipe, fittings or valves of the same nominal size
- Sizes from 2–12" | DN50–DN300
- Refer to the publication for maximum pressure ratings and temperature reduction factors
- Regional availability, contact [Victaulic](#) for details

### Certifications/Listings:



[Download publication 02.06](#) for ANSI/NSF Potable Water Approvals/Listings



## Reducing Coupling STYLE 358

[Download publication 33.08](#) for complete information

- Exclusively for use on CPVC/PVC pipe featuring Victaulic's proprietary PGS-300 groove profile
- Sizes from 2½ × 2" – 10 × 8" | 73.0 mm × DN50–DN250 × DN200
- Refer to the publication for maximum pressure ratings and temperature reduction factors
- Regional availability, contact [Victaulic](#) for details

### Certifications/Listings:



[Download publication 02.06](#) for ANSI/NSF Potable Water Approvals/Listings

## CPVC/PVC System



## PGS-300 Grooved End Fittings

[Download publication 33.03](#) for complete information

- Exclusively for use on CPVC/PVC pipe featuring Victaulic's proprietary PGS-300 groove profile
- Sizes from 2–12" | DN50–DN300
- Refer to the publication for maximum pressure ratings and temperature reduction factors
- Regional availability, contact [Victaulic](#) for details

## Certifications/Listings:



[Download publication 02.06](#) for ANSI/NSF Potable Water Approvals/Listings

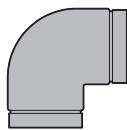

**No. 350**  
90° Elbow

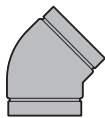

**No. 351**  
45° Elbow

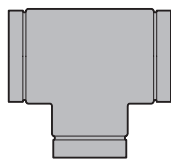

**No. 352**  
Tee

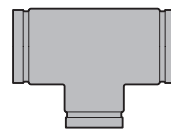

**No. 353**  
Reducing Tee  
(Groove × Groove  
× Groove)

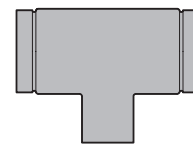

**No. 354**  
Reducing Tee  
(Groove × Groove  
× Socket)

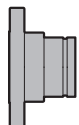

**No. 359F**  
Flange Adapter  
(Groove × Flange)

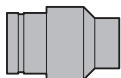

**No. 361**  
Reducing Adapter  
(Groove × Socket)





## PGS-300 Grooved End Expansion Joint

### STYLE 355

[Download publication 33.05](#) for complete information

- Exclusively for use on CPVC/PVC pipe featuring Victaulic's proprietary PGS-300 groove profile
- Provides increased axial expansion and full axial movement at each joint
- Combination of Style 357 rigid couplings and short grooved nipples, joined in tandem to provide increased expansion
- Victaulic® Grade "EHP" gasket is UL Classified in accordance with ANSI/NSF 61 and 372 for potable water service
- Sizes from 2–12" | DN50–DN300
- Refer to the publication for maximum pressure ratings and temperature reduction factors
- Regional availability, contact [Victaulic](#) for details

## Pipe Preparation Tools

The world's leading developer of pipe preparation tools, and inventor of the original groove, has been providing the industry with in-place, field and shop model tools since the 1940s. From ½" | DN15 through 78" | DN1950; for carbon steel through plastic pipe; and a wide variety of accessories, these tools will simplify your work in the field or on the shop floor. The Victaulic® line of intelligent roll grooving tools offer instant feedback on the quality of the groove, reducing rework and increasing operator safety.







### Field Portable Roll Grooving Tools

	VE12	121
	RG1200	121
	VE26	122
	VE46	122
	VE226	123
	RG3600	123





### Field Fabrication Roll Grooving Tools

	VE106/VE107	124
	VE206	124
	VE272SFS	125
	VE270FSD/VE271FSD	125
	VE416FS	126
	VE416FSD/VE417FSD	126
	VE450FSD	127
	RG3210	127



### Plant/Shop Fabrication Roll Grooving Tools

	VE268	128
	VE414MC	128
	50T	129
	VE460	130
	RG5200i	131

### Field Fabrication Cut Grooving Tools

	VG	131
	VG28GD, VG28GD-ABR, VDG26GD, VG26GD-COR	132
	VG824, VG824-ABR, VG824DG, VG824-COR	133
	VG828	134
	VG412	134

### Cut Grooving Tools for Plastic Pipe

	CG1100	135
	VPG824	135
	CG3100, CG3300, CG3500	136



**Aquamine™ Grooving Tool**



APG

page

136

**Hole Cutting Tools**



HCT904

page

137



HCT908

137



VHCT900

138



VIC-TAP II

138



Style 926 Spigot Hole Cut Saw

139

**Pipe Cut-Off Tools**



PC3110

page

139



VCT1 Manual

140



VCT2 Automatic

140

**Vic-Press™ Tool**



PFT510

page

141

**Tool Accessories**

pages



Power Mule II

141



Adjustable Pipe Stands

142 – 143



Pipe Preparation Measuring Tools

144 – 145



System Safety Test Accessories

146

**Closure Tools**

page



VBSP Closure Tools

146

**Fabrication Cell**

page



VAP131

147



VAPS 131R

147



VAPS 131F

148



VAPS 131T

148

## Pipe Preparation Tools

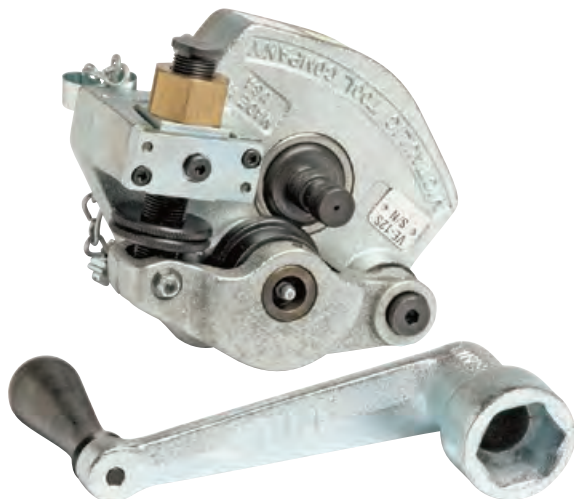

### Field Portable Roll Grooving Tools

#### VE12 GROOVE IN-PLACE

[Download publication 24.01](#) for complete information

- Roll grooves  $\frac{3}{4}$ –2" | DN20–DN50 pipe
- For manual grooving of Schedule 5, 10 and 40 steel; stainless steel; aluminum and PVC pipe (size dependent)
- Tool is manually operated using the supplied handle
- Enhanced tracking rolls allow bi-directional grooving
- Power Requirements: None
- Weight: 17 lbs. | 8 kg



### Field Portable Roll Grooving Tools

#### RG1200 OGS-200 GROOVE IN-PLACE

[Download publication 24.11](#) for complete information

- Roll grooves 2–6" | DN50–DN150 pipe
- Designed to provide a Victaulic® OGS-200 roll groove in Schedules 40 and 80 carbon steel pipe
- Tool is manually operated using the supplied handle
- Enhanced tracking rolls allow bi-directional grooving
- Power Requirements: None
- Weight: 27 lbs. | 12 kg



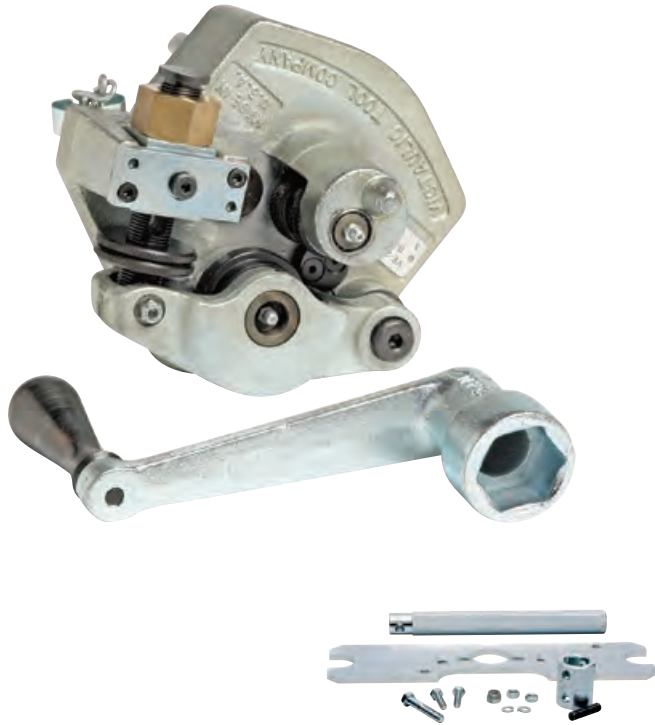

## Field Portable Roll Grooving Tools

### VE26 GROOVE IN-PLACE

[Download publication 24.01](#) for complete information

- Roll grooves 2–6" | DN50–DN150 pipe
- For manual grooving of Schedule 5, 10 and 40 steel; stainless steel; aluminum and PVC pipe; K, L, M, DWV, A, B and D copper tube (size dependent)
- Tool is manually operated using the supplied handle
- Enhanced tracking rolls allow bi-directional grooving
- Optional power drive kit available to alternately groove pipe using a Ridgid™ 300 power drive. Newer tools with serial numbers ending in “C” are compatible with the Power Drive Kit; tools which do not contain the “C” suffix will require retrofit to accept the Power Drive Kit; contact Victaulic for details.
- Power Requirements: None
- Tool Weight: 22 lbs. | 10 kg  
Optional Power Drive Kit Weight: 7 lbs. | 3 kg



## Field Portable Roll Grooving Tools

### VE46 GROOVE IN-PLACE

[Download publication 24.01](#) for complete information

- Roll grooves 3½–6" | DN90–DN150 pipe
- For manual grooving of Schedule 5, 10 and 40 steel; stainless steel and aluminum pipe; Schedule 40 – 80 PVC pipe (size dependent)
- Tool is manually operated using the supplied handle
- Enhanced tracking rolls allow bi-directional grooving and help to hold the tool on the pipe end during the roll grooving process
- Optional power drive kit available to alternately groove pipe using a Ridgid™ 300 power drive. Newer tools with serial numbers ending in “C” are compatible with the Power Drive Kit; tools which do not contain the “C” suffix will require retrofit to accept the Power Drive Kit; contact Victaulic for details.
- Power Requirements: None
- Tool Weight: 28 lbs. | 13 kg  
Optional Power Drive Kit Weight: 7 lbs. | 3 kg



## Pipe Preparation Tools



### Field Portable Roll Grooving Tools

#### VE226 PORTABLE GROOVER

[Download publication 24.01](#) for complete information

- Roll grooves ¾–6" | DN20–DN150 pipe
- For grooving of Schedule 5, 10 and 40 steel; stainless steel; aluminum and PVC pipe; K, L, M, DWV, A, B and D copper tube (size dependent)
- Tool is operated using a standard ¾" | 9.5 mm square ratchet drive (not included)
- Drive Requirements: Mounts to Ridgid™ 300 Power Drive; optional bases available
- Kit required for connecting a VE226 roll grooving tool to a Ridgid™ 700 Power Drive
- Tool Weight: 37 lbs. | 17 kg  
Optional Power Drive Kit Weight: 75 lbs. | 34 kg

### Field Portable Roll Grooving Tools

#### RG3600 StrenghThin™ 100 Portable Groover

[Download publication 24.08](#) for complete information



- Roll grooves 2–12" | DN50–DN300 1.4301/1.4307 (Type 304/304L) or 1.4401/1.4404 (Type 316/316L) stainless steel pipe per EN 10217-7; 2–6" | DN50–DN150, 1.6–2.7 mm wall thickness and 8–12" | DN200–DN300, 2.0–4.5 mm wall thickness
- Drive Requirements: Compatible with REMS Amigo 2 and Ridgid™ 700 power drive
- Power Requirements: 230VAC 50/60 hertz
- Optional tripod stand kit available
- Tool Weight: 29 lbs. | 55 kg
- Regional availability, contact [Victaulic](#) for details



## Field Fabrication Roll Grooving Tools

### VE106/VE107 GROOVE-N-GO

[Download publication 24.01](#) for complete information

- Roll grooves 1¼–6" | DN32–DN150 pipe
- For grooving of Schedule 5, 10 and 40 steel and stainless steel pipe; K, L, M and DWV copper tube (size dependent)
- Mobile light-duty roll grooving tool with an integral motor/drive unit mounted to portable hand truck
- Reduces pipe handling by allowing the tool to be wheeled directly to the pipe preparation site
- ¾" | 9.5 mm square ratchet drive for operation (standard)
- Enhanced tracking rolls help to keep the pipe on the tool during the roll grooving process
- Completely self-contained unit with an integral motor, safety foot switch and power plug
- Power Requirements:  
VE106 is provided with 110 volt, 15 amp power;  
VE107 is provided with 220 volt, 6 amp power
- Weight: 140 lbs. | 64 kg



## Field Fabrication Roll Grooving Tools

### STYLE VE206

[Download publication 24.01](#) for complete information

- Roll grooves 1¼–6" | DN32–DN150
- For grooving of Schedule 5, 10 and 40 steel and stainless steel pipe; K, L, M and DWV copper tube (size dependent)
- Tool head mounts to any tripod stand with a Ridgid™ 300 bolt pattern or the flat bed of a work truck
- Hydraulic hand pump can be mounted on either side of the tool for right or left hand operation
- Supplied with Victaulic® tool carry bag for accessory storage
- Power Requirements: compatible with multiple power drive units: Ridgid™ 300, Ridgid™ 700 and REMS Amigo 2
- Weight: 165 lbs. | 75 kg

## Pipe Preparation Tools



### Field Fabrication Roll Grooving Tools

VE272SFS

[Download publication 24.01](#) for complete information

- Roll grooves ¾ – 12" | DN20 – DN300 pipe
- For grooving of Schedule 5, 10, 40 and 80 steel; stainless steel; aluminum and PVC pipe; K, L, M and DWV copper tube (size dependent)
- Hand pump operation with a unique pivot arm design reduces handle effort
- Enhanced tracking rolls help to keep the pipe on the tool during the roll grooving process
- The fully-motorized, semi-automatic, electrohydraulic tool comes complete with safety guards and safety foot switch
- Power Requirements: Ridgid™ 300 Power Drive
- Weight: 184 lbs. | 84 kg



### Field Fabrication Roll Grooving Tools

VE270FSD/VE271FSD

[Download publication 24.01](#) for complete information

- Roll grooves ¾ – 12" | DN20 – DN300 pipe
- For grooving of Schedule 5, 10, 40 and 80 steel; stainless steel; aluminum and PVC pipe; K, L, M and DWV copper tube (size dependent)
- Completely self-contained unit with integral gear motor, safety guards, safety foot switch and power cord/plug
- Equipped with a unique pivot arm design, making roll changing quick and easy without removing shafts
- Enhanced tracking rolls help to keep the pipe on the tool during the roll grooving process
- The fully-motorized, semi-automatic, electrohydraulic tool comes complete with safety guards and safety foot switch
- Power Requirements:  
VE270FSD is provided with 110 volt, 15 amp power;  
VE271FSD is provided with 220 volt, 6 amp power
- Weight: 340 lbs. | 154 kg



## Field Fabrication Roll Grooving Tools

### VE416FS

[Download publication 24.01](#) for complete information

- Roll grooves 2–16" | DN50–DN400 pipe
- For grooving of Schedule 5, 10, 40 and 80 steel; stainless steel; aluminum and PVC pipe; K, L, M and DWV copper tube (size dependent)
- VE416FS is designed for field grooving of OGS pipe and should not be used for continuous field production grooving; for field production grooving capabilities, use a VE450FSD tool, see pg. 127
- Equipped with a pipe stabilizer for 6–16" | DN150–DN400 pipe sizes to control pipe sway
- Groove depth adjuster allows for easy adjustment for initial groove diameter
- The fully-motorized, semi-automatic, electrohydraulic tool comes complete with safety guards and safety foot switch
- Power Requirements: Ridgid™ 300 Power Drive
- Weight: 240 lbs. | 109 kg



## Field Fabrication Roll Grooving Tools

### VE416FSD/VE417FSD

[Download publication 24.01](#) for complete information

- Roll grooves 2–16" | DN50–DN400 pipe
- For grooving of Schedule 5, 10, 40 and 80 steel; stainless steel; aluminum and PVC pipe; K, L, M and DWV copper tube (size dependent)
- VE416FSD/VE417FSD is designed for field grooving of OGS pipe and should not be used for continuous field production grooving; for field production grooving capabilities, use a VE450FSD tool, see pg. 127
- Groove depth adjuster allows for easy adjustment for initial groove diameter
- Completely self-contained unit with integral gear motor, safety foot switch and power cord/plug
- The fully-motorized, semi-automatic, electrohydraulic tool comes complete with safety guards and safety foot switch
- Power Requirements: VE416FSD is provided with 110volt, 15 amp for integral gear motor; VE417FSD is provided with 220volt, 8 amp service
- Weight: 340 lbs. | 154 kg



## Pipe Preparation Tools

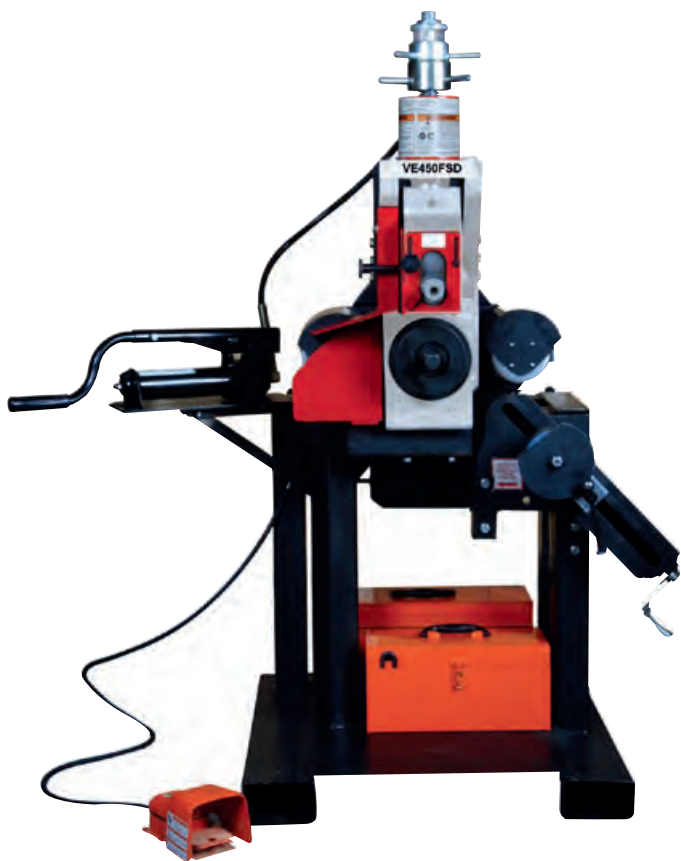

### Field Fabrication Roll Grooving Tools

#### VE450FSD

[Download publication 24.01](#) for complete information

- Roll grooves 4–24" | DN100–DN600 pipe
- For grooving of Schedule 5, 10, 40 and 80 steel; stainless steel; aluminum and PVC pipe; K, L, M and DWV copper tube (size dependent)
- The VE450FSD is designed for field production grooving and not continuous fabrication shop production grooving
- Enhanced tracking rolls help to keep the pipe on the tool during the roll grooving process, and quickly change upper roll design
- Lifting point to move the tool using a crane
- Frame can accept most forklifts
- Onboard storage for tool accessories
- Power Requirements: self-contained unit with two 220 volt, single phase 50/60 hertz, 20 amp integral gear motors to handle heavier loads, safety foot switch and power cord/plug
- Weight: 825 lbs. | 374 kg

### Field Fabrication Roll Grooving Tools

#### RG3210

[Download publication 24.18](#) for complete information



- Roll grooves 2–12" | 60.3–323.9 mm pipe
- For grooving carbon steel wall thicknesses ranging from 2.77–6.35 mm
- Hydraulic-feed shop or field tool
- Anti-flare roll grooving capability to control pipe end flare
- Power Requirements: 220 volt, 1.5 kW, 50/60 hertz, Single Phase
- Weight: 302 lbs. | 137 kg





## Plant/Shop Fabrication Roll Grooving Tools

VE268

[Download publication 24.01](#) for complete information

- Roll grooves ¾–12" | DN20–DN300 pipe
- For grooving of Schedule 5, 10, 40 and 80 steel; stainless steel; aluminum and PVC pipe; K, L, M and DWV copper tube (size dependent)
- The fully-motorized, semi-automatic, electrohydraulic tool comes complete with safety guards and safety foot switch
- Equipped with a unique pivot arm design, making roll changes quick and easy, without removing shafts
- Enhanced tracking rolls help to keep the pipe on the tool during the roll grooving process
- Power Requirements: 220/440 volt, 3-phase, 60 hertz standard; the tool can also be supplied in various voltages, contact Victaulic for details
- 3-phase requires tool power to be hard wired by a local certified electrician
- Weight: 735 lbs. | 333 kg



## Plant/Shop Fabrication Roll Grooving Tools

VE414MC

[Download publication 24.01](#) for complete information

- Roll grooves 2–16" | DN50–DN400 pipe
- For grooving of Schedule 5, 10, 40 and 80 steel; stainless steel; aluminum and PVC pipe; K, L, M and DWV copper tube (size dependent)
- The fully-motorized, semi-automatic, electrohydraulic tool comes complete with safety guards and safety foot switch
- Roll changes are quick and easy, without removing shafts
- Enhanced tracking rolls help to keep the pipe on the tool during the roll grooving process
- Power Requirements: 220/440 volt, 3-phase, 60 hertz standard; the tool can also be supplied in various voltages, contact Victaulic for details
- 3-phase requires tool power to be hard wired by a local certified electrician
- Weight: 735 lbs. | 333 kg



## Plant/Shop Fabrication Roll Grooving Tools

50T

[Download publication 24.03](#) for complete information

- Roll grooves 14–78" | DN350–DN1950 pipe
- Wall thickness capability varies on size; Reference publication 24.03 for more details
- Production roll grooving tool designed for fabrication shop use
- Power Requirements: 480 volt, 3-phase, 60 hertz standard; the tool can also be supplied in various voltages, contact Victaulic for details
- 3-phase requires tool power to be hard wired by a local certified electrician
- Weight: 3800 lbs. | 1724 kg



## Plant/Shop Fabrication Roll Grooving Tools

VE460

[Download publication 24.03](#) for complete information

- Roll grooves 4–24" | DN100–DN600 pipe with Original Groove System (OGS)
- For grooving of Schedule 5, 10, 40 and 80 steel; stainless steel; aluminum and PVC pipe (size dependent)
- Roll grooves 14–60" | DN350–DN1500 pipe with Advanced Groove System (AGS)
- For grooving of .250–.500 wall carbon steel; Schedule 5S and 10S stainless steel (size dependent)
- The fully-motorized, semi-automatic, electrohydraulic tool comes complete with safety guards and safety foot switch
- Enhanced tracking rolls help to keep the pipe on the tool during the roll grooving process
- Support bases are required to groove pipe sizes 26" | DN650 and larger. Each support base is 12" | 305 mm in height and corresponds with a range of allowable pipe sizes it can groove
- Power Requirements: 220/440 volt, 3-phase, 60 hertz standard; the tool can also be supplied in various voltages, contact Victaulic for details
- 3-phase requires tool power to be hard wired by a local certified electrician
- Weight: 1500 lbs. | 680 kg

Intro

OGS

AGS

VBSP

Hole Cut

Plain End

Stainless Steel

Copper

Shouldered Steel

Ductile Iron

High Performance

Hydraulic Balancing

HDPE

Aquamine™ PVC

CPVC/PVC

Tools

Gaskets, Seals and O-Rings

Design Data

Reference Guide

## Pipe Preparation Tools



## Plant/Shop Fabrication Roll Grooving Tools

RG5200i

[Download publication 24.05](#) for complete information

- Fully-automated, hydraulic shop tool is shipped fully assembled with proximity scanner, control stand and rolls for standard grooving Schedule 10–40 pipe
- Available with stainless steel roll sets (4–12" | DN100–DN300)
- Enhanced tracking rolls help to keep the pipe on the tool during the roll grooving process
- Drive Requirements: self-contained
- Power Requirements: 208/240 volt, 3-phase, 50/60 hertz standard; the tool can also be supplied for use with various global voltage connections, contact Victaulic for details
- 3-phase requires tool power to be hard wired by a local certified electrician
- Weight: 1300 lbs. | 590 kg



## Field Fabrication Cut Grooving Tools

VG VIC-GROOVER

[Download publication 24.01](#) for complete information

- Cut grooves  $\frac{3}{4}$ –8" | DN20–DN200 pipe
- For grooving of Schedule 40 through 80 steel; stainless steel; aluminum and CPVC/PVC pipe; Class 53 Min ductile iron (size dependent)
- Designed for manual or power cut grooving
- Supplied with a ratchet handle for manual operation
- Drive Requirements: manual or external drive, min.  $\frac{1}{2}$  hp | 0.37 kw
- External power drives must meet all local/regional safety requirements
- Drive Speed: 40 rpm max.
- Weight: 28 lbs. | 13 kg



## Field Fabrication Cut Grooving Tools

VG28GD (GEAR DRIVE)

VG28GD-ABR (ABRASION)

VDG26GD (DOUBLE GROOVE)

VG26GD-COR (CORROSION)

[Download publication 24.01](#) for complete information

- Cut grooves 2–8" | DN50–DN200 pipe
- For grooving of Schedule 40 through 80 steel; stainless steel and aluminum pipe; Class 53 Min ductile iron (size dependent)
- VG28GD will produce a single Victaulic® OGS cut groove for unlined piping systems
- VG28GD-ABR will produce a single *Victaulic* OGS cut groove that allows for lining of the pipe for abrasive services
- VDG26GD will produce a double *Victaulic* OGS cut groove for high pressure systems in conjunction with installing the 6" | DN150 Style 808 couplings
- VG26GD-COR will cut groove carbon steel pipe in preparation for being rubber lined and machined for abrasion and corrosion resistance
- The VG28GD, VG28GD-ABR, VDG26GD, and VG26GD-COR are designed to be driven by the Power Mule II
- Drive Requirements: external drive, min. 1½ hp | 1.12 kw
- Drive Speed: 38 rpm max.
- Weight: 37 lbs. | 17 kg

Intro

OGS

AGS

VBSP

Hole Cut

Plain End

Stainless Steel

Copper

Shouldered Steel

Ductile Iron

High Performance

Hydraulic Balancing

HDPE

Aquamine™ PVC

CPVC/PVC

Tools

Gaskets, Seals and O-Rings

Design Data

Reference Guide



## Pipe Preparation Tools

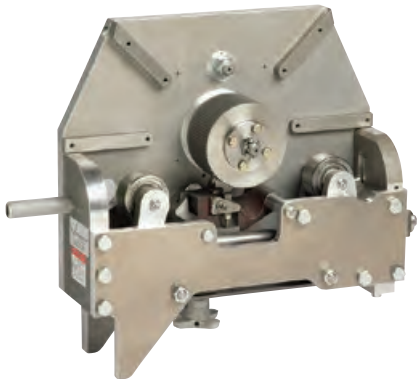

## Field Fabrication Cut Grooving Tools

**VG824 (OGS)**

**VG824-ABR (ABRASION OGS)**

**VG824DG (DOUBLE GROOVE)**

**VG824-COR (CORROSION OGS)**

[Download publication 24.01](#) for complete information

- Cut grooves 8–24" | DN200–DN600 pipe
- For grooving of Schedule 30 through 80 steel; stainless steel and aluminum pipe; Class 53 Min ductile iron (size dependent)
- VG824 will produce a single Victaulic® OGS cut groove for unlined piping systems
- VG824-ABR will produce a single *Victaulic* OGS cut groove that allows for lining of the pipe for abrasive services
- VG824DG will produce a double *Victaulic* OGS cut groove for high pressure piping systems in conjunction with installing 8–12" | DN200–DN300 Style 808 couplings
- VG824-COR will cut groove carbon steel pipe in preparation for being rubber lined and machined for abrasion and corrosion resistance
- The VG824, VG824DG, VG824-ABR and VG824-COR are designed to be driven by the Power Mule II
- Drive Requirements: External drive, min. 1½ hp | 1.12 kw
- Drive Speed: 38 rpm max.
- Weight: 82 lbs. | 37.2 kg

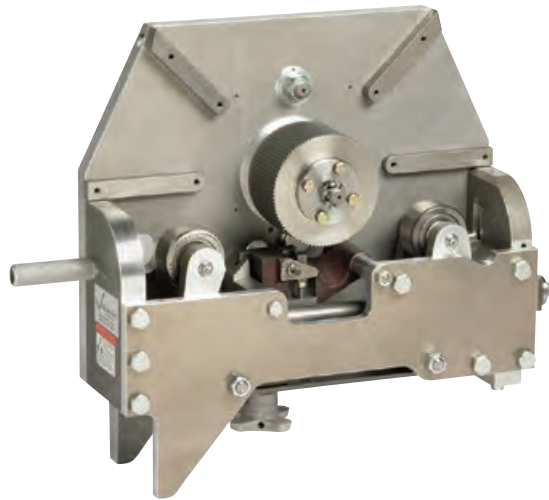

## Field Fabrication Cut Grooving Tools

VG828 (AGS)

[Download publication 24.01](#) for complete information

- Cut grooves 14–24" | DN350–DN600 pipe
- For grooving of .500–.750 wall steel pipe
- VG828 will produce a single Victaulic® AGS cut groove
- The VG828 is designed to be driven by the Power Mule II
- Drive Requirements: External drive, min. 1½ hp | 1.12 kw
- Drive Speed: 38 rpm max.
- Weight: 82 lbs. | 37.2 kg



## Field Fabrication Cut Grooving Tools

VG412 ORBITAL MACHINING TOOL

[Download publication 24.01](#) for complete information

- Cut grooves 4–12" | DN100–DN300 pipe
- For grooving of Schedule 40 through 80 steel; Class 53 Min ductile iron
- Specifically designed for field closure pieces (not suitable for production grooving)
- External mounting and drive action is particularly suited to cement lined ductile iron pipe grooving
- Hinged frame design allows cutting at any point along the pipeline
- Drive Requirements: 120 volt, 11.5 amp
- Weight: 151 lbs. | 69 kg

## Pipe Preparation Tools



### Cut Grooving Tools for Plastic Pipe CG1100

[Download publication 24.09](#) for complete information

- Cut grooves 2–12" | DN50–DN250 pipe
- For grooving of Schedule 40 through 80 CPVC/PVC pipe
- Features the Victaulic® PGS-300 cut groove profile
- Power Requirements: 120 volt, 50/60 hertz, 7 amp
- Weight: 17 lbs. | 7.7 kg



### Cut Grooving Tools for Plastic Pipe VPG824

[Download publication 24.01](#) for complete information

- Cut grooves 8–16" | DN200–DN400 pipe
- For grooving of Schedule 40 through 80 PVC pipe
- Features a high speed, router-type tool bit which cuts a radial groove, to full depth, in one manual rotation of the tool around the pipe
- Rotation Drive: Manual (clockwise)
- Power Requirements: 110 volt, single phase, 60 hertz, 7 amp
- Weight: 47 lbs. | 21 kg

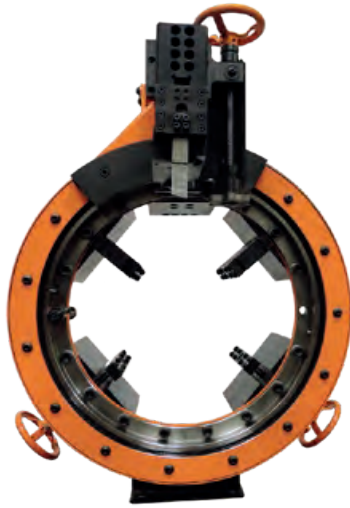

## Field Fabrication Cut Grooving Tool for HDPE Pipe

CG3100, CG3300, CG3500 (HDPE)

[Download publication 24.06](#) for complete information

- Cut grooves 8–36" IPS and 250–900 mm ISO HDPE pipe
- For grooving of SDR 7–21 pipe
- The tool mounts on the exterior pipe wall and cuts and grooves the end of the pipe in a single operation
- The CG3100 and CG3300 tools connect directly to a 120 volt, 50/60 hertz, 20 amp power source (An optional 220 volt, single phase, 50/60 hertz model is also available)
- The CG3500 tool connects directly to a 220 volt, single phase, 50/60 hertz, 20 amp power source
- Weight: CG3100: 430 lbs. | 195 kg, CG3300: 580 lbs. | 263 kg, CG3500: 715 lbs. | 324 kg



## Aquamine™ Grooving Tool

APG

[Download publication 24.01](#) for complete information

- Prepares 4–12" | DN100–DN300 *Aquamine* pipe
- Manually operated tool used for producing a cut spline groove and beveled end on *Aquamine* PVC pipe
- Orbital tool which is rotated around a stationary, secured pipe
- May be operated on pipe held in a pipe vise or on supported in-place piping that is depressurized and drained
- Weight: 13 lbs. | 5.9 kg

## Pipe Preparation Tools



### Hole Cutting Tools

HCT904

[Download publication 24.01](#) for complete information

- One-piece hole cutting tool designed to cut holes up to 2¾" | 70 mm in carbon and stainless steel pipe; for pipe sizes up to 8" | DN200
- Allows use of *Mechanical-T* outlets, strapless outlets, and strapless thermometer outlets
- Power Requirements: 220 volt, single phase, 60 hertz, 10 amp
- Weight: 23 lbs. | 10 kg
- Regional availability, contact [Victaulic](#) for details



### Hole Cutting Tools

HCT908

[Download publication 24.01](#) for complete information

- One-piece hole cutting tool designed to cut holes up to 2¾" | 70 mm in carbon and stainless steel pipe; for pipe sizes up to 8" | DN200
- Allows use of *Mechanical-T* outlets, strapless outlets, and strapless thermometer outlets
- Power Requirements: 110 volt, single phase, 60 hertz, 7 amp
- Weight: 23 lbs. | 10 kg





## Hole Cutting Tools

VHCT900

[Download publication 24.01](#) for complete information

- Three-piece hole cutting tool designed to cut holes up to 4½" | 120 mm in diameter for *Mechanical-T* outlets, strapless outlets, and strapless thermometer outlets
- Base unit clamps quickly onto the pipe in vertical, horizontal or overhead positions
- Available extended chain for 10–24" | DN250–DN600 pipe
- Power Requirements: grounded 120 volt, single phase, 60 hertz, 10 amp electrical supply (220 volt, single phase, 60 hertz, 5 amp available on request)
- Weight: 36 lbs. | 16 kg



## Hole Cutting Tools

VIC-TAP II

[Download publication 24.01](#) for complete information

- Hole cutting tool including Style 931 *Vic-Tap II Mechanical-T* unit for tapping into steel pipe systems under pressure up to 500 psi | 3447 kPa | 34 bar
- Hole size 2¾" | 60.5 mm
- Power Requirements: 115 volt, single phase, 60 hertz, 7.5 amp
- Weight:  
Drill guide base: 15 lbs. | 6.8 kg; Drill motor and feed assembly: 16 lbs. | 7.3 kg; Style 931 valve unit, 12–15 lbs. | 5.4–6.8 kg, depending upon size (4" | DN100, 5" | 141.3 mm, 6" | DN150 and 8" | DN200 available)
- Standard Capability: 4–8" | DN100–DN200  
Run outlet only × 2½" | 73.0 mm (IPS) Outlet

## Pipe Preparation Tools



### Style 926 Spigot Hole Cut Saw for HDPE Pipe

[Download publication 11.07](#) for complete information

- Designed to cut 4" | DN100 and 6" | DN150 holes in HDPE pipe
- Allows use of Style 926 *Mechanical-T* Spigot Outlet



### QuickVic™ SD Cut and Mark Tool PC3110

[Download publication 34.01](#) for complete information

- Lightweight pipe cut-off tool handles ½–2" | DN15–DN50 Schedule 10–80 carbon steel pipe
- Marks the outside diameter of the pipe with insertion marks for proper installation of the QuickVic™ SD couplings and fittings
- Designed for use on a power drive
- Power Requirements: NA
- Weight: 10.3lbs. | 4.7 kg

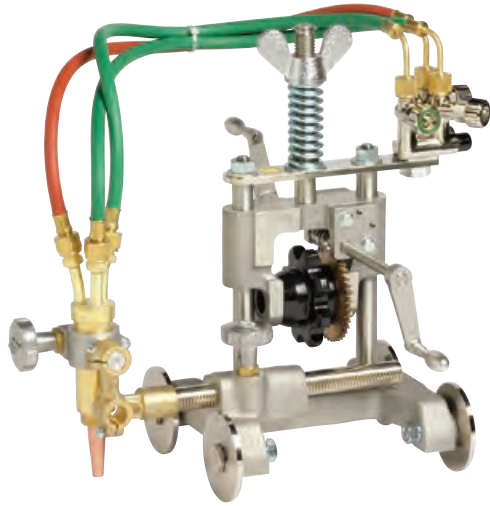

## Pipe Cut-Off Tools

### VCT1 MANUAL

[Download publication 24.01](#) for complete information

- Lightweight and portable pipe cut-off tool handles 4–24" | DN100–DN600 pipe, up to 0.5" | 12.7 mm thick
- Worm gear drive crank handle provides smooth, manual travel, easy control and accurate cutting
- Wall thickness: 0.065–0.500" | 1.65–12.7 mm (with tips supplied)
- Tips: Acetylene–1 ea. #00, #0, #1
- Power Requirements: NA
- Weight: 22 lbs. | 10 kg

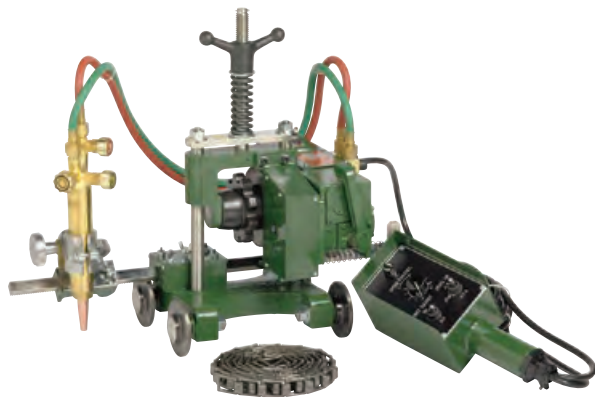

## Pipe Cut-Off Tools

### VCT2 AUTOMATIC

[Download publication 24.01](#) for complete information

- Rotation is powered by a small 120VAC motor with SCR remote control
- Unique distributor design has stainless steel insert which extends tip life, eases cleaning and reduces backfire
- Wall thickness: 0.065–0.500" | 1.65–12.7 mm (with tips supplied)
- Tips: Acetylene–1 ea. #00, #0, #1
- Motor rating: 15W, 10,000 rpm
- Power requirements: 120 volt, single phase, 60 hertz, 15 amp
- Weight: 33 lbs. | 15 kg

## Pipe Preparation Tools



## Vic-Press™ Tools

### PFT510

[Download publication 24.01](#) for complete information

- Designed for securing Vic-Press™ Schedule 10S products onto Schedule 10S stainless steel pipe
- Tool package includes:
  - (1) PFT510 tool,
  - (2) 18V Lithium Ion batteries,
  - (1) battery charger,
  - (1) tool carrying case,
  - (1) jaw carrying case,
  - (1) each of jaws sized ½" | DN15, ¾" | DN20, 1" | DN25, 1½" | DN40, and 2" | DN50, and
  - (1) adapter jaw
- Not compatible with PFT505 and/or PFT509 tools/components
- Power Requirements: Battery pack 110volt, 60cycle, 6.5amp (optional 220volt)
- Weight: 21 lbs. | 9.5kg (PFT510 with 1" | DN25 jaw)



## Tool Accessories

### POWER MULE II

[Download publication 24.01](#) for complete information

- Ideal for driving individual Victaulic® cut grooving tools
- Heavy-duty, two wheeled unit drives *Victaulic* cut grooving tools at the speed/power necessary for accurate grooving
- Rotating head for horizontal and vertical applications
- Power Mule II equipped with forward-off-reverse control and integral safety foot switch
- Full load speed: 35 rpm
- Power Requirements: 115 volts, 15 amp, 50/60 cycle (220 volts optional)
- Weight: 190lbs. | 86kg



## Tool Accessories

### VAPS112 ADJUSTABLE PIPE STAND

[Download publication 24.01](#) for complete information

- Designed for supporting pipe to be roll grooved
- Turnstile design allows pipe to be spun around for grooving of both pipe ends without dismounting pipe from stand
- Forward/traverse movement
- Capacity: ¾–12" | DN20–DN300 pipe
- Load rating: 1,075 lbs. | 490 kg
- Vertical stroke: The legs adjust from 8½" | 216 mm to achieve table height of 23" | 584 mm
- Minimum pipe height from floor: 23" | 584 mm on 12" | DN300 pipe and 21" | 533 mm on 1" | DN25 pipe
- Weight: 190 lbs. | 86 kg



## Tool Accessories

### VAPS224 ADJUSTABLE PIPE STAND

[Download publication 24.01](#) for complete information

- Designed specifically for supporting pipe to be roll grooved
- Self-standing, heavy-duty unit permits free pipe rotation and traversing on ball transfers
- Capacity: 2–24" | DN50–DN600 pipe
- Load rating: 1,800 lbs. | 816 kg
- Vertical stroke: 23" | 584 mm
- Minimum pipe height from floor 13" | 325 mm on 24" | DN600 pipe
- Maximum pipe height from floor 38" | 965 mm on 2" | DN50 pipe
- Weight: 260 lbs. | 118 kg



## Pipe Preparation Tools



### Tool Accessories

#### VAPS1672 ADJUSTABLE PIPE STAND

[Download publication 24.01](#) for complete information

- Designed specifically for supporting pipe to be roll grooved
- Self-standing, heavy duty unit permits free pipe rotation and traversing on ball transfers
- Designed for use with VE460 grooving tools
- Capacity: 16 – 72" | DN400 – DN1800 pipe
- Load rating: 10,000 lbs. | 4535 kg
- Vertical Stroke: 17" | 425 mm
- Minimum pipe height from floor 16" | 406 mm on 72" | DN1800 pipe
- Maximum pipe height from floor 28" | 711 mm on 16" | DN400 pipe
- Weight: 480 lbs. | 218 kg



### Tool Accessories

#### VAPS270 ADJUSTABLE PIPE STAND

[Download publication 24.01](#) for complete information

- Designed specifically for supporting pipe to be roll grooved
- Self-standing, heavy duty unit permits free pipe rotation and traversing on ball transfers
- Designed for use with VE270FSD, VE271FSD and VE272SFS grooving tools
- Capacity: ¾ – 12" | DN20 – DN300 pipe
- Load rating: 660 lbs. | 300 kg
- Turnstile design allows grooving of both pipe ends without dismounting pipe from stand
- Minimum pipe height from floor: 25" | 630 mm
- Maximum pipe height from floor: 37" | 930 mm
- Weight: 44 lbs. | 20 kg
- Regional availability, contact [Victaulic](#) for details



## Tool Accessories

### GROOVE DIAMETER CABLES FOR COPPER TUBING

Go/No-Go pocket-sized groove diameter cables for taking circumferential measurements of copper tubing

- GDC-CTS cable should only be used to check roll-grooved tubing to CTS Standard Types K, L, M hard-drawn copper tubing per ASTM B-88 and DMV per ASTM B-306 specifications (2–8" | 54.0 – 206.4 mm tubing sizes)
- GDC-EC cable should only be used to check roll-grooved tubing to European Standard EN 1057 R250 (Half-Hard) specifications (54 – 159 mm tubing sizes).
- GDC-AC cable should only be used to check roll-grooved tubing to Australian Standard AS 1432 Types A, B and D copper tubing specifications (50 – 200 mm tubing sizes)

### GROOVE DIAMETER CABLE FOR VICTAULIC® STRENGTHIN™ 100 SYSTEM FOR THIN WALL STAINLESS STEEL

Go/No-Go pocket-sized groove diameter cables are available for taking circumferential measurements on stainless steel pipe in sizes 2 – 12" | DN50 – DN300

- GDC-STRENGTHIN100 cable should only be used to check roll grooved pipe conformance to *Victaulic StrenGThin* 100 groove diameter specifications
- To ensure proper grooving dimensions, always refer to the I-E497 *StrenGThin* 100 Installation instructions or to the latest groove specifications publications located on [victaulic.com](http://victaulic.com)

### GROOVE DIAMETER CABLE FOR VICTAULIC PGS-300 SYSTEM FOR CPVC/PVC PIPE

Go/No-Go pocket-sized groove diameter cables are available for taking circumferential measurements on CPVC/PVC pipe in sizes 2 – 12" | DN50 – DN300

- GDC-PGS-300 cable should only be used to check cut grooved pipe conformance to *Victaulic* PGS-300 groove diameter specifications
- This cable is a quick reference guide and is not a replacement for a calibrated diameter measuring instrument. To ensure proper grooving dimensions, always refer to the relevant installation instructions or to the latest groove specifications publication located on [victaulic.com](http://victaulic.com).

## Pipe Preparation Tools



## Tool Accessories

### PT100A, PT101 AND PT102A

[Download publication 24.01](#) for complete information

- Go/No-Go pocket-sized steel tapes for taking circumferential measurements of pipe
- Go/No-Go side can be used to check cut or roll grooved pipe for conformance to Victaulic® grooved pipe specifications
- Tapes notched on the lead end to allow proper overlap within the groove for more accurate measurement
- PT100A contains Go/No-Go markings for use with ¾–24" | DN20–DN600 pipe; tape marked with 0.01" | 0.25 mm increments on the opposite side
- PT-101 contains Go/No-Go markings for use with DN20–DN600 pipe; tape marked with 0.25 mm increments on the opposite side
- PT102A contains Go/No-Go markings for use with Original Groove System sizes 8–12" | DN200–DN300 and Advanced Groove System sizes 14–72" | DN350–DN1800; tape marked in 0.02" | 0.5 mm increments on the opposite side



## Tool Accessories

### RG1200 GROOVE CONFIRMATION GAUGE SET

- Supplied with RG1200 roll grooving tool for easy groove confirmation
- Does not require tool to be removed from pipe to check the groove depth
- Used in conjunction with the PT100A or PT101A depending on the region

### HDPE GROOVE CONFIRMATION GAUGE SET

- Designed to check HDPE cut grooves to ensure they meet *Victaulic* specifications
- Always refer to the HDPE Field Installation Handbook ([I-900](#)) or Victaulic's HDPE Cut Groove Specifications ([publication 25.16](#))



## System Safety Test Accessories

### NO. T-60 TEST CAP KIT

[Download publication 24.07](#) for complete information

- Allows user another means to verify system is unpressurized and empty of test media before continuing work
- Packaged in stackable, heavy-duty rolling case
- Includes 2–8" | DN50–DN200 IPS test caps
- Individual test caps 2–12" | DN50–DN300 can be ordered separately



## Victaulic® Bolted Split-Sleeve Products (VBSP) Closure Tools

CTM-01 SMALL MANUAL TOOL

CTM-02 LARGE MANUAL TOOL

CTH-01 SMALL 10-TON HYDRAULIC TOOL

CTH-02 LARGE 25-TON HYDRAULIC TOOL

[Download publication 24.01](#) for complete information

- For specific information on the appropriate tool by coupling, please download individual coupling product publications



## Pipe Preparation Tools

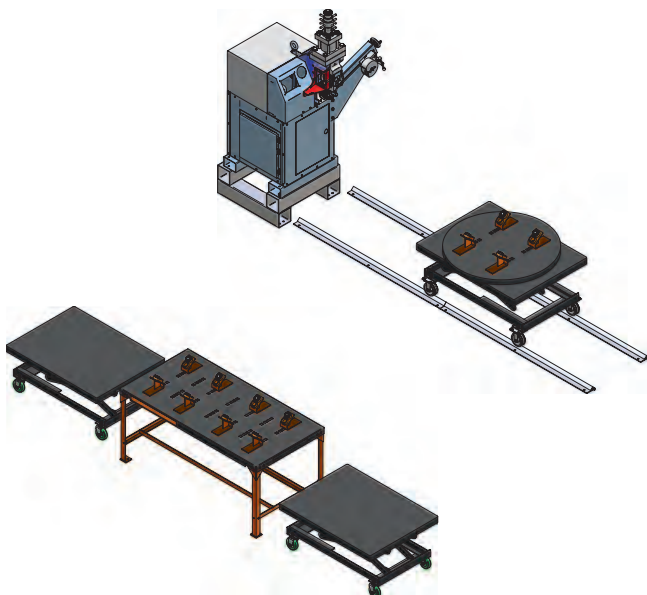

## Fabrication Cell

VAP131

[Download publication 24.01](#) for complete information

- Turn-key, fab-shop solution
- Maximizes productivity gains associated with Victaulic® grooved systems
- Includes hydraulic adjustable pipe stand and tracks, tool support, two adjustable positioner tables, an assembly table, as well as caster wheels and ball transfers

## Hydraulic Adjustable Pipe Stand for Fabrication Cell

VAPS 131R

[Download publication 24.01](#) for complete information

- Designed to support pipe for roll grooving
- Permits free pipe rotation and traversing on ball transfers
- Turnstile design allows pipe to be spun around for grooving of both pipe ends without dismantling from pipe stand
- Capacity: 4–24" | DN100–DN600 pipe; load rating: 2000 lbs. | 907 kg
- Vertical stroke: 30.5" | 775 mm
- Minimum pipe height from floor: compatible with Victaulic production roll grooving tools
- Power Requirements: 230 volt, 6 amp, 50 hertz (120 volt, 12 amp, 60 hertz option available)
- Weight: 500 lbs. | 227 kg







## Hydraulic Positioner for Fabrication Cell

VAPS 131F

[Download publication 24.01](#) for complete information

- Designed to support grooved pipe, valves, and fittings when used in conjunction with the VAPS 131T Assembly Table
- Foot control provided for hands-free operation
- Swivel caster wheel design for better mobility
- Capacity: 4–24" | DN100–DN600 pipe; load rating: 1200 lbs. | 544 kg with wheels installed, 2000 lbs. | 907 kg without wheels
- Vertical stroke: 29.25" | 743 mm
- Power Requirements: 230 volt, 6 amp, 50 hertz (120 volt, 12 amp, 60 hertz option available)
- Weight: 400 lbs. | 181 kg



## Assembly Table for Fabrication Cell

VAPS 131T

[Download publication 24.01](#) for complete information

- Designed to support grooved pipe, valves, and fittings when used in conjunction with VAPS 131F Hydraulic Positioner
- Ball transfer assemblies can be positioned to accommodate pipe from 2–24" | DN50–DN600
- Capacity: 4–24" | DN100–DN600 pipe; load rating: 8000 lbs. | 3629 kg, ball transfers load rating 700 lbs. | 318 kg
- Vertical stroke: 29.25" | 743 mm
- Weight: 500 lbs. | 227 kg

### Gaskets/Seals/O-Rings

Victaulic offers a broad variety of synthetic rubber gaskets suitable for a wide range of applications. Victaulic® gaskets can accommodate high and low temperature extremes without loss of their chemical and physical properties. Refer to the *Victaulic Seal Selection Guide*, [publication 05.01](#) for a complete list.

For specific chemical and temperature compatibility, refer to the *Victaulic Gasket Chemical Services Guide* — Long Report ([GSG-100](#)) located on [victaulic.com](http://victaulic.com).



Installation-Ready™



Traditional C-Shape



Reducing

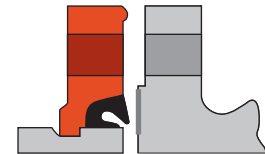

Vic-Flange



Flush-Seal™



Grooved Copper Tubing with *Flush-Seal* Gasket



Advanced Groove System (AGS)



EndSeal™

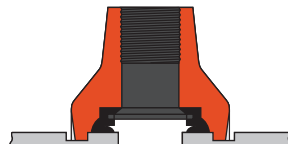

Outlet



*Mechanical-T*



IPS to AWWA Transition



*AWWA Flush-Seal*



Plain End



Plain End for HDPE Pipe



unpressed      pressed  
Vic-Press™ for Schedule 10S Stainless Steel



FRP



Victaulic® Bolted Split-Sleeve Products (VBSP)



Shouldered Steel System



Style 809N for Ring Systems

## Gasket Seal Data

Victaulic offers a variety of synthetic elastomeric gaskets for a wide range of applications. To assure the maximum life for the service intended, proper gasket selection is essential.

Many factors can affect the performance and longevity of a gasket. These factors include, but are not limited to temperature, fluid, concentrations, a combination of fluids and duration of service. Temperatures outside of the design limits or use with incompatible fluids can reduce the performance capability of the gasket and service life.

Services listed are General Service Guidelines for each of the three associated product areas. It should be noted that there are services for which these gaskets, seals and o-ring are not compatible. Reference should always be made to the Gasket Chemical Services Guide for each Victaulic® gasket Grade for specific service guidelines and for a listing of services which are not compatible.

Gasket, seals and o-ring guidelines apply only to *Victaulic* gaskets, seals and o-ring. Guidelines for a particular service does not necessarily imply compatibility of the coupling housing, related fittings, or other components for the same service. *Victaulic* gaskets are marked with the gasket size, style, and associated compound for identification.

## Potable Water

Grade “E” EPDM, Grade “E” Vic-Plus™, Grade “EHP”, Grade “EHP” *Vic-Plus*, Grade “E2” and Grade “EW” gaskets are UL Classified in accordance with ANSI/NSF 61 for cold +73°F | +23°C and hot +180°F | +82°C potable water service and ANSI/NSF 372.

Similarly, *Victaulic* Grade “M” halogenated butyl gasket material (which is used with *Victaulic* ductile iron pipe sized products) is UL Classified in accordance with ANSI/NSF 61 for cold +73°F | +23°C potable water systems and ANSI/NSF 372. See Victaulic [Publication 02.06](#) for more details.

The data provided is intended for use as an aid to qualified designers and specifiers when products are installed in accordance with the latest available *Victaulic* product line.

## Valve Seals

Victaulic Seal Selection Guide (05.01) does not include *Victaulic* seals for valves. Refer to the individual Victaulic valve publication for information on the seals available for each valve.

## Reference Materials

[02.06: Victaulic Potable Water Approvals ANSI/NSF](#)

[05.01: Victaulic Seal Selection Guide](#)

[05.02: Victaulic Lubricant MSDS Sheet](#)

[05.02-EU: Victaulic Lubricant MSDS Sheet \(Europe Only\)](#)

[05.03: Victaulic Vic-Plus™ MSDS Sheet](#)

[GSG-100: Victaulic Gasket Chemical Services Guide — Long Report](#)

### CAUTION

- To ensure maximum product performance for the intended service, always specify the proper elastomer or seal material. Refer to the “Gasket Selection” and Chemical Services” sections located within this document.
- For specific chemical and temperature compatibility, always refer to the “Gasket Chemical Services Guide — Long Report” (GSG-100), which can be downloaded at victaulic.com.

**Failure to select and specify the proper elastomer or seal material for the intended service may cause joint failure, resulting in property damage.**

## Design Data

### Introduction

This Victaulic® General Catalog has been written for the piping system installer, designer, specification writer and owner as a basic reference guide for data about *Victaulic* mechanical piping methods. This catalog is organized to provide information in the context and form most readily usable. For easy identification of major sections of interest, see the condensed table of contents on pg. i, for a quick reference guide, see pg. 152. For more detailed information, [download Design Data 26.01](#).

### Important Information

*Victaulic* standard grooved pipe couplings are designed for use with pipe grooved to meet *Victaulic* groove specifications and *Victaulic* grooved end fittings, valves, and related grooved end components only. They are not intended for use with plain end pipe and/or fittings. *Victaulic* plain end couplings are designed for use only with plain end or beveled end steel pipe (unless otherwise indicated) and *Victaulic* plain end fittings. ***Victaulic* plain end couplings must not be used with grooved end or threaded end pipe and/or fittings. Nor are they intended for use with Advanced Groove System (AGS) components used on 14–78" | DN350–DN1950 pipe sizes.**

Pipe must be prepared to meet *Victaulic* specifications outlined for each specific product style. Performance data listed herein is based on proper pipe preparation. The proper gasket must be selected for the service intended. **It should be noted that there are various services for which *Victaulic* gaskets are not recommended. Reference should always be made to the latest *Victaulic* Seal Selection Guide ([download publication 05.01](#)) for specific gasket service recommendations and for a listing of services which are not recommended. Gaskets for *Victaulic* products always must be lubricated for proper assembly.** Gasket lubricant must meet manufacturer's specifications. Thorough lubrication of the gasket exterior, including the lips and/or pipe ends and housing interiors, is essential to prevent gasket pinching. Lubrication assists proper gasket seating and alignment during installation.

*Victaulic* has a complete line of tools for preparing pipe to *Victaulic* specifications. Use of these tools is recommended in preparing pipe to receive *Victaulic* products. Always read and understand the Tool Operating Instructions supplied with every *Victaulic* tool prior to using any tools. All data contained herein, is subject to change without notice.

### Notice

The technical and performance data, weights, dimensions and specifications published in this catalog supersede all previously published data.

*Victaulic* maintains a policy of continual product improvement and, therefore, reserves the right to change product specifications, designs, and standard equipment without notice and without incurring obligation.

For the most up-to-date *Victaulic* product information, please visit [victaulic.com](http://victaulic.com).

The material presented in this catalog is intended for piping design reference in utilization of *Victaulic* products for their intended application. It is not intended as a substitute for competent, professional assistance which is an obvious requisite to any specific application.

### Design

Reference should always be made to design information available at no charge on request from *Victaulic*. Good piping practices should always prevail. Specific pressures, temperatures, external or internal loads, performance standards and tolerances must never be exceeded. Many applications require recognition of special conditions, code requirements and use of safety factors. Qualified engineers must make these decisions.

While every effort has been made to ensure its accuracy, *Victaulic*, its subsidiaries and affiliated companies, make no express or implied warranty of any kind respecting the information contained in this catalog or the material referred to herein.

Anyone making use of the information or material contained herein does so at their own risk and assumes any and all liability resulting from such use.

### Installation

Reference should always be made to the specific *Victaulic* Field Installation Handbook or Manual for the product you are installing.

Handbooks and Manuals are included with each shipment of *Victaulic* products for complete installation and assembly data, and are available in PDF format on our website at [victaulic.com](http://victaulic.com).

Model	Product Description	Pages	Publication
<b>Original Groove System (OGS)</b>			
Style 107N	QuickVic™ Rigid Coupling	3	<a href="#">06.23</a>
Style 177N	QuickVic™ Flexible Coupling	3	<a href="#">06.24</a>
Style 07	Zero-Flex™ Rigid Coupling	3	<a href="#">06.02</a>
Style 77	Flexible Coupling	4	<a href="#">06.04</a>
Style 75	Flexible Coupling	4	<a href="#">06.05</a>
Style 750	Reducing Coupling	4	<a href="#">06.08</a>
Style 78	Snap-Joint™ Coupling	5	<a href="#">06.09</a>
Style 791/792	<i>Vic-Boltless</i> Coupling and Tool	5	<a href="#">06.11</a>
Style HP-70	High Pressure Rigid Coupling	5	<a href="#">06.12</a>
Style 72	Outlet Coupling	46	<a href="#">06.10</a>
Style 41	<i>Vic-Ring</i> Coupling	6	<a href="#">16.04</a>
Style 44	<i>Vic-Ring</i> Coupling	6	<a href="#">16.05</a>
Style 741	<i>Vic-Flange</i> Adapter	7	<a href="#">06.06</a>
Style 743	<i>Vic-Flange</i> Adapter	7	<a href="#">06.06</a>
—	OGS Fittings	8–10	<a href="#">07.01</a>
Style 150	<i>Mover</i> Expansion Joint	11	<a href="#">09.04</a>
Style 155	Expansion Joint	11	<a href="#">09.05</a>
Series 761	Vic-300™ MasterSeal™ Butterfly Valve	12	<a href="#">08.20</a>
Series 700	Butterfly Valve	12	<a href="#">08.05</a>
Series 716H	High Pressure <i>Vic-Check</i> Valve	13	<a href="#">08.08</a>
Series 716	<i>Vic-Check</i> Valve	13	<a href="#">08.08</a>
Series 779	Venturi Check Valve	13	<a href="#">08.10</a>
Series 712	Swing Check Valve	14	<a href="#">08.11</a>
Series 713	Swing Check Valve	14	<a href="#">08.54</a>
Series 721	<i>Vic-Ball</i> Valve	14	<a href="#">08.14</a>
Series 726	<i>Vic-Ball</i> Valve	15	<a href="#">08.23</a>
Series 727	Ball Valve	15	<a href="#">08.42</a>
Series 722	Brass Body Ball Valve — Threaded	15	<a href="#">08.15</a>
Series 377	<i>Vic-Plug</i> Valve	16	<a href="#">08.12</a>
Style DLY	Delta-Y Valve Assembly	16	<a href="#">07.08</a>
Series 795	Knife Gate Valve	16	<a href="#">08.25</a>
Series 771M	OS&Y Gate Valve	17	<a href="#">08.45</a>
Series 723	Three Port Diverter	17	<a href="#">08.13</a>
Series 725S	Diverter Valve	17	<a href="#">08.41</a>
Series 910	Hydraulic Control Valve (Bermad Series 100)	18	<a href="#">100</a>
Series 970	Hydraulic Control Valve (Bermad Series 700)	18	<a href="#">700</a>
Series 980	Hydraulic Control Valve (Bermad Series 800)	18	<a href="#">800</a>
Series 9A3	Automatic Air Release Valve (Bermad Series A30)	19	<a href="#">A30</a>
Series 9A7	Automatic Air Release Valve (Bermad Series A71)	19	<a href="#">A71</a>
Series 9C3	Combination Air Valve (Bermad Series C30)	19	<a href="#">C30</a>
Series 9C5	Combination Air Valve (Bermad Series C50)	20	<a href="#">C50</a>
Series 9C7	Combination Air Valve (Bermad Series C70)	20	<a href="#">C70</a>
Series 731-D	Suction Diffuser	21	<a href="#">09.20</a>
Series 730	<i>Vic-Strainer</i> Tee Type	21	<a href="#">09.02</a>
Series 732	<i>Vic-Strainer</i> Wye Type	21	<a href="#">09.03</a>
No.26	Vic™-Header	22	<a href="#">07.11</a>
Series 385	Vibration Isolation Air Handling Unit Drop	22	<a href="#">102.15</a>
Series 386	Pressure Reducing Valve Station	22	<a href="#">102.16</a>
Series 381/381G	Inlet Suction Diffuser VIPD – North America	23	<a href="#">102.11</a>
Series 391	Inlet Suction Diffuser VIPD – Rest of World	23	<a href="#">102.21</a>
Series 331	Inlet Suction Diffuser VIPD – Hong Kong	23	<a href="#">102.31</a>
Series 334	Inlet Suction Diffuser VIPD – Taiwan	23	<a href="#">102.34</a>
Series 337	Inlet Suction Diffuser VIPD – Korea	23	<a href="#">102.37</a>
Series 382/382G	Inlet Strainer VIPD – North America	23	<a href="#">102.12</a>
Series 392	Inlet Strainer VIPD – Rest of World	23	<a href="#">102.22</a>

Model	Product Description	Pages	Publication
Series 332	Inlet Strainer VIPD – Hong Kong	23	<a href="#">102.32</a>
Series 380/380G	Outlet Discharge VIPD – North America	24	<a href="#">102.10</a>
Series 390	Outlet Discharge VIPD – Rest of World	24	<a href="#">102.20</a>
Series 330	Outlet Discharge VIPD – Hong Kong	24	<a href="#">102.30</a>
Series 333	Outlet Discharge VIPD – Taiwan	24	<a href="#">102.33</a>
Series 336	Outlet Discharge VIPD – Korea	24	<a href="#">102.36</a>
Series 383/383G	Outlet Discharge VIPD with Balancing Valve – North America	24	<a href="#">102.13</a>
Style HP-70ES	EndSeal™ Coupling	25	<a href="#">06.13</a>
—	EndSeal™ Fittings	25	<a href="#">07.03</a>
Style 808	High Pressure Double Grooved Coupling	26	<a href="#">15.01</a>
Style 809N	High Pressure Ring Coupling	26	<a href="#">15.03</a>
Style 171	Composite Flexible Coupling	26	<a href="#">06.22</a>
—	XL (Extended Life) System for Rubber-Lined Abrasive Services	27	<a href="#">07.07</a>
Style 152A	Expansion Joint Coupling	27	<a href="#">09.15</a>
Style 296-A	Coupling for Fiberglass Reinforced Plastic Pipe	28	<a href="#">90.01</a>
Style 229S	Non-Restrained Flexible Coupling for Fiberglass Reinforced Plastic Pipe	28	<a href="#">60.16</a>
Style 77A	Flexible Aluminum Coupling	29	<a href="#">21.01</a>
Style 78A	Snap-Joint™ Aluminum Coupling	29	<a href="#">21.02</a>
—	Aluminum Fittings	30	<a href="#">21.03</a>
Style 926	<i>Mechanical-T</i> Spigot Outlet	47	<a href="#">11.07</a>
—	Style 926 Spigot Hole Cut Saw for HDPE Pipe	139	<a href="#">11.07</a>
<b>Advanced Groove System (AGS)</b>			
Style W07	AGS Rigid Coupling	32	<a href="#">20.02</a>
Style W77	AGS Flexible Coupling	32	<a href="#">20.03</a>
Style W89	AGS Rigid Coupling	32	<a href="#">20.15</a>
Style W07	AGS Rigid Coupling with <i>Vic-Ring</i>	33	<a href="#">16.11</a>
Style W77	AGS Flexible Coupling with <i>Vic-Ring</i>	33	<a href="#">16.12</a>
Style W89	AGS Rigid Coupling with <i>Vic-Ring</i>	33	<a href="#">16.15</a>
—	AGS Fittings	34	<a href="#">20.05</a>
—	AGS Stainless Steel Schedule 10S Fittings	35	<a href="#">17.05</a>
Style W741	AGS <i>Vic-Flange</i> Adapter	35	<a href="#">20.04</a>
Style W155	AGS Expansion Joint	35	<a href="#">20.12</a>
Style W256	AGS Expansion Barrel	36	<a href="#">09.16</a>
Style W257	AGS Dynamic Movement Joint	36	<a href="#">20.16</a>
Series W761	AGS Vic-300™ Butterfly Valve	36	<a href="#">20.06</a>
Series W709	AGS Butterfly Valve	37	<a href="#">20.07</a>
Series W719	AGS Butterfly Valve	37	<a href="#">23.19</a>
Series W715	AGS <i>Vic-Check</i> Double Disc Valve	37	<a href="#">20.08</a>
Series W731-D	AGS Suction Diffuser	38	<a href="#">20.20</a>
Series W730	AGS <i>Vic-Strainer</i> Tee Type	38	<a href="#">20.11</a>
Series W732	AGS <i>Vic-Strainer</i> Wye Type	38	<a href="#">20.19</a>
No.26	<i>Vic-Header</i>	22	<a href="#">07.11</a>
<b>Victaulic® Bolted Split-Sleeve Products (VBSP)</b>			
Style 229S	Non-Restrained Flexible Coupling for Fiberglass Reinforced Plastic Pipe	28	<a href="#">60.16</a>
Style 230	Non-Restrained Flexible Coupling for Carbon Steel Pipe	40	<a href="#">60.01</a>
Style 230S	Non-Restrained Flexible Coupling for Stainless Steel Pipe	40	<a href="#">60.02</a>
Style 231	Non-Restrained Flexible Expansion Coupling for Carbon	40	<a href="#">60.03</a>
Style 231S	Non-Restrained Flexible Expansion Coupling for Stainless	41	<a href="#">60.04</a>
Style 232	Restrained Flexible Coupling for Carbon Steel Pipe	41	<a href="#">60.05</a>
Style 232S	Restrained Flexible Coupling for Stainless Steel Pipe	41	<a href="#">60.06</a>
Style 233	Restrained Flexible Coupling for Dynamic Joint Deflection on Carbon Steel Pipe	42	<a href="#">60.07</a>
Style 233S	Restrained Flexible Coupling for Dynamic Joint Deflection on Stainless Steel Pipe	42	<a href="#">60.08</a>



## Reference Guide

Model	Product Description	Pages	Publication
Style 234	Restrained Flexible Single-Gasket Coupling for Carbon Steel Pipe	43	<a href="#">60.09</a>
Style 234S	Restrained Flexible Single-Gasket Coupling for Stainless Steel Pipe	43	<a href="#">60.10</a>
Style 240	Stainless Steel Bellow Expansion Joint	44	<a href="#">60.13</a>
CTM-01	VBSP Small Manual Closure Tool	146	<a href="#">24.01</a>
CTM-02	VBSP Large Manual Closure Tool	146	<a href="#">24.01</a>
CTH-01	VBSP Small 10-Ton Hydraulic Closure Tool	146	<a href="#">24.01</a>
CTH-02	VBSP Large 25-Ton Hydraulic Closure Tool	146	<a href="#">24.01</a>
<b>Hole Cut System</b>			
Style 920/920N	<i>Mechanical-T</i> Bolted Branch Outlet and Cross Assemblies	46	<a href="#">11.02</a>
Style 422	Stainless Steel <i>Mechanical-T</i> Bolted Branch Outlet	60	<a href="#">17.02</a>
Style 622	<i>Mechanical-T</i> Bolted Branch Outlet and Cross Assemblies for CTS Copper	77	<a href="#">22.12</a>
Style 72	Outlet Coupling	46	<a href="#">06.10</a>
Style 923	Strapless Outlet	47	<a href="#">11.05</a>
Style 924	Strapless Thermometer Outlet	47	<a href="#">11.06</a>
Style 926	<i>Mechanical-T</i> Spigot Outlet	47	<a href="#">11.07</a>
HCT904	Hole Cutting Tools	137	<a href="#">24.01</a>
HCT908	Hole Cutting Tools	137	<a href="#">24.01</a>
VHCT900	Hole Cutting Tools	138	<a href="#">24.01</a>
VIC-TAP II	Hole Cutting Tools	138	<a href="#">24.01</a>
—	Style 926 Spigot Hole Cut Saw for HDPE Pipe	139	<a href="#">11.07</a>
<b>Plain End System for Carbon Steel</b>			
<b>QuickVic™ SD Installation-Ready™ System</b>			
Style P07	QuickVic™ SD Installation-Ready™ Rigid Coupling	50	<a href="#">34.01</a>
Style P08	QuickVic™ SD Installation-Ready™ Slip Coupling	50	<a href="#">34.01</a>
Style P50	QuickVic™ SD Installation-Ready™ Reducing Coupling	50	<a href="#">34.01</a>
—	QuickVic™ SD Installation-Ready™ Fittings	51	<a href="#">34.01</a>
—	QuickVic™ SD Threaded Adapters	52	<a href="#">34.01</a>
—	QuickVic™ SD Dielectric Adapters	52	<a href="#">34.01</a>
Series P89	QuickVic™ SD Ball Valve	52	<a href="#">34.01</a>
PC3110	QuickVic™ SD Cut and Mark Tool	139	<a href="#">34.01</a>
<b>Plain End System</b>			
Style 99	<i>Roust-A-Bout</i> Plain End Coupling	53	<a href="#">14.02</a>
—	Plain End Fittings for Carbon Steel	54	<a href="#">14.04</a>
<b>Stainless Steel System</b>			
<b>Original Groove System</b>			
Style 489	Type 316 Rigid Coupling	58	<a href="#">17.25</a>
Style 89	Rigid Coupling for Stainless Steel	58	<a href="#">17.24</a>
Style 489DX	Duplex Rigid Coupling	58	<a href="#">17.33</a>
Style 77S	Type 316 Flexible Coupling	59	<a href="#">17.03</a>
Style 47S	Type 316 Lightweight Flexible Coupling	59	<a href="#">17.14</a>
Style 77DX	Duplex Flexible Coupling	59	<a href="#">17.20</a>
Style 475DX	Duplex Lightweight Flexible Coupling	60	<a href="#">17.34</a>
Style 441	Type 316 <i>Vic-Flange</i> Adapter	60	<a href="#">17.27</a>
Style 422	Stainless Steel <i>Mechanical-T</i> Bolted Branch Outlet	60	<a href="#">17.02</a>
—	Stainless Steel Schedule 10S Fittings	61	<a href="#">17.16</a>
—	Stainless Steel Schedule 40S Fittings	62	<a href="#">17.16</a>
Series 461	Vic-300™ MasterSeal™ Stainless Steel Butterfly Valve	63	<a href="#">17.40</a>
Series 416	Stainless Steel Check Valve	63	<a href="#">17.41</a>
Series 712S	Stainless Steel Swing Check Valve	63	<a href="#">17.08</a>
Series 415	Duplex Double Disc Check Valve	64	<a href="#">17.37</a>
Series 726S	Type 316 <i>Vic-Ball</i> Valve	64	<a href="#">17.22</a>
Series 726D	Super Duplex Vic-Ball Valve	64	<a href="#">17.28</a>
Series 465	Duplex Plug Valve	65	<a href="#">17.36</a>

Model	Product Description	Pages	Publication
<b>Advanced Groove System</b>			
Style W89	AGS Rigid Coupling for Stainless Steel	32	<a href="#">20.15</a>
Style W89	AGS Rigid Coupling with <i>Vic-Ring</i> for Stainless Steel	33	<a href="#">16.15</a>
—	AGS Stainless Steel Schedule 10S Fittings	35	<a href="#">17.05</a>
<b>Vic-Press™ System</b>			
—	Vic-Press™ For Schedule 10S Stainless Steel Type 304	66	<a href="#">18.12</a>
—	Vic-Press™ For Schedule 10S Stainless Steel Type 316	67	<a href="#">18.11</a>
Series P569	Three-Piece Vic-Press™ Ball Valve	65	<a href="#">18.14</a>
PFT510	Vic-Press™ Tool	141	<a href="#">24.01</a>
<b>StrengThin™ System</b>			
Style D08	StrengThin™ High Pressure Rigid Coupling	68	<a href="#">17.30</a>
—	StrengThin™ High Pressure Fittings	68	<a href="#">17.32</a>
Series 415	Duplex Double Disc Check Valve	64	<a href="#">17.37</a>
Series 465	Duplex Plug Valve	65	<a href="#">17.36</a>
<b>StrengThin™ 100 System</b>			
Style E497	StrengThin™ 100 Rigid Coupling	69	<a href="#">31.02</a>
—	StrengThin™ 100 Fittings	69	<a href="#">31.04</a>
Series E125	StrengThin™ 100 Installation-Ready™ Butterfly Valve	70	<a href="#">31.05</a>
Series E461	StrengThin™ 100 Vic-300™ MasterSeal™ Stainless Steel Butterfly Valve	70	<a href="#">17.40</a>
Series E416	StrengThin™ 100 Stainless Steel Check Valve	70	<a href="#">17.41</a>
Style E155	StrengThin™ 100 Expansion Joint	71	<a href="#">31.07</a>
RG3600	StrengThin™ 100 Portable Groover	123	<a href="#">24.08</a>
<b>High Performance System for Stainless Steel</b>			
Style 870	High Performance Rigid Coupling for Steam and Chemical Services	89	<a href="#">100.02</a>
—	OGS-200 Grooved End Fittings	90	<a href="#">100.01</a>
<b>Copper System</b>			
Style 607	QuickVic™ Rigid Coupling for CTS Copper	74	<a href="#">22.13</a>
Style 606-AS	Rigid Coupling for Australian Standard Copper	74	<a href="#">22.51</a>
Style 606	Rigid Coupling for European Copper	74	<a href="#">22.11</a>
Style 644	Installation-Ready™ Transition Coupling for CTS Copper to Stainless Steel for Potable Water	74	<a href="#">22.44</a>
Style 641	<i>Vic-Flange</i> Adapter for CTS Copper	75	<a href="#">22.03</a>
Style 641	<i>Vic-Flange</i> Adapter for European Copper	75	<a href="#">22.11</a>
Style 647	Dielectric Fitting for CTS Copper	75	<a href="#">22.21</a>
—	Fittings for CTS Copper	76	<a href="#">22.04</a>
—	Fittings for Australian Standard Copper	76	<a href="#">22.52</a>
—	Fittings for European Copper	76	<a href="#">22.11</a>
Series 608N	Butterfly Valve for CTS Copper	77	<a href="#">22.14</a>
Series 608N-AS	Butterfly Valve for Australian Standard Copper	77	<a href="#">22.53</a>
Style 622	<i>Mechanical-T</i> Bolted Branch Outlet and Cross Assemblies for CTS Copper	77	<a href="#">22.12</a>
<b>Shouldered Steel System</b>			
Style SC77	Installation-Ready™ Flexible Coupling for Shouldered Steel Pipe	80	<a href="#">16.10</a>
Style SC85	Flexible Coupling for Shouldered Steel Pipe	80	<a href="#">16.21</a>
Style SC998	Transition Coupling for HDPE to Shouldered Steel	80	<a href="#">19.08</a>
—	Shouldered Steel Fittings	81	<a href="#">07.06</a>
Series 752	Shouldered Gate Valve	82	<a href="#">08.44</a>
Series 761SC	Shouldered Butterfly Valve	82	<a href="#">08.31</a>

Model	Product Description	Pages	Publication
<b>Ductile Iron System</b>			
Style 31	Coupling for Ductile Iron	84	<a href="#">23.02</a>
Style 307	Transition Coupling for IPS to Ductile Iron	84	<a href="#">23.03</a>
Style 341	<i>Vic-Flange</i> Adapter for Ductile Iron	84	<a href="#">23.04</a>
—	Fittings for Ductile Iron	85–86	<a href="#">23.05</a>
Series 317	Check Valve for Ductile Iron	87	<a href="#">23.09</a>
Series 365	<i>Vic-Plug</i> Valve for Ductile Iron	87	<a href="#">23.06</a>
Style 926	<i>Mechanical-T</i> Spigot Outlet	47	<a href="#">11.07</a>
—	Style 926 Spigot Hole Cut Saw for HDPE Pipe	139	<a href="#">11.07</a>
<b>High Performance System for Steam and Chemical Services</b>			
Style 870	High Performance Rigid Coupling for Steam and Chemical Services	89	<a href="#">100.02</a>
—	OGS-200 Grooved End Fittings	90	<a href="#">100.01</a>
Series 871	Gate Valve	90	<a href="#">100.12</a>
Series 159	Flexible Loop	90	<a href="#">100.13</a>
RG1200	OGS-200 Field Portable Roll Grooving Tool	121	<a href="#">24.11</a>
<b>Hydronic Balancing Solutions</b>			
TA Series 786	Manual Balancing Valves (Solder End)	93	<a href="#">08.16</a>
TA Series 787H	Manual Balancing Valves (Female Threaded End)	93	<a href="#">08.16</a>
Series 78KH	Manual Balancing Valves (Union Inlet)	93	<a href="#">08.16</a>
TA Series 788	Manual Balancing Valves (Class 150 Flanged End)	93	<a href="#">08.16</a>
TA Series 789	Manual Balancing Valves (Grooved End)	93	<a href="#">08.16</a>
TA Series 78BL	Manual Balancing Ball Valve	94	<a href="#">08.50</a>
Series 76T	Automatic Balancing Valves (Threaded End)	94	<a href="#">08.34</a>
Series 76K	Automatic Balancing Valves (Threaded End)	94	<a href="#">08.34</a>
Series 76B	Automatic Balancing Valve with Ball Valve Kit (Threaded End)	95	<a href="#">08.34</a>
Series 76V	Automatic Balancing Valve with Ball Valve Kit (Threaded End)	95	<a href="#">08.34</a>
Series 76G	Automatic Balancing Valves (Grooved End)	95	<a href="#">08.34</a>
TA Series 76X	ICSS Low Lead Balancing Valve	96	<a href="#">08.51</a>
TA Series TC	Terminal Balancing and Control Valve	96	<a href="#">08.38</a>
TA Series TCM	Terminal Balancing Valve for Modulating Control	96	<a href="#">08.38</a>
TA Series 7FP	Pressure Independent Balancing and Control Valve (PIBCV)	97	<a href="#">08.53</a>
TA Series 7CP	Compact Pressure Independent Balancing and Control Valve	98	<a href="#">08.37</a>
TA Series 7MP	Pressure Independent Balancing and Modulating Control Valve	98	<a href="#">08.55</a>
TA Series 7CT	Control Valve with Return Temperature Controller	98	<a href="#">08.36</a>
TA Series 793	Differential Pressure Controller— Female Threaded End	99	<a href="#">08.29</a>
TA Series 794	Differential Pressure Controller— Flanged End	99	<a href="#">08.29</a>
TA Series 7PR	Differential Pressure Controller— Flanged End	99	<a href="#">08.46</a>
Series 799	Standard KOIL-KIT™ Coil Pack	100	<a href="#">08.30</a>
Series 79B	KOIL-KIT™ Coil Pack with ATC and Bypass Options	100	<a href="#">08.30</a>
Series 79A	KOIL-KIT™ Coil Pack with ATC and Bypass Options	100	<a href="#">08.30</a>
Series 79C	KOIL-KIT™ Coil Pack for Air Handling Units	101	<a href="#">08.35</a>
Series 79D	KOIL-KIT™ Coil Pack for Air Handling Units	101	<a href="#">08.35</a>
—	KOIL-KIT™ Coil Hose	101	<a href="#">08.30</a>
Series 78Y	KOIL-KIT™ Y-Strainer/Ball Valve Combination	102	<a href="#">08.30</a>
Series 78T	KOIL-KIT™ Ball Valve/Union Combination	102	<a href="#">08.30</a>
Series 78U	KOIL-KIT™ Union Port Fitting	102	<a href="#">08.30</a>
TA Series 734	TA Scope™	103	<a href="#">08.16</a>
TA Series 736	Link Differential Pressure Sensor	103	<a href="#">08.16</a>
Series 385	Vibration Isolation Air Handling Unit Drop	22	<a href="#">102.15</a>
<b>System Solution for HDPE Pipe</b>			
Style 905	Coupling for Plain End HDPE Pipe	106	<a href="#">19.07</a>
Style 907	Transition Coupling for HDPE-to-Steel Pipe	106	<a href="#">19.10</a>
Style 908	Coupling for Double Grooved HDPE Pipe	106	<a href="#">19.09</a>
Style SC998	Transition Coupling for HDPE to Shouldered Steel	80	<a href="#">19.08</a>

Model	Product Description	Pages	Publication
Series 2971	Aquamine™ Transition Coupling for PVC to HDPE	111	<a href="#">50.05</a>
Style 904	Flange Adapter for HDPE-to-Flanged Pipe	107	<a href="#">19.12</a>
—	Plain End HDPE Fittings	107	<a href="#">19.11</a>
Series 906	Knife Gate Valve for HDPE Pipe	107	<a href="#">19.06</a>
Style 920/920N	<i>Mechanical-T</i> Bolted Branch Outlet and Cross Assemblies	46	<a href="#">11.02</a>
Style 422	Stainless Steel <i>Mechanical-T</i> Bolted Branch Outlet	60	<a href="#">17.02</a>
Style 926	<i>Mechanical-T</i> Spigot Outlet	47	<a href="#">11.07</a>
—	Style 926 Spigot Hole Cut Saw for HDPE Pipe	139	<a href="#">11.07</a>
CG3100 CG3300 CG3500	Field Fabrication Cut Grooving Tool for HDPE Pipe	136	<a href="#">24.06</a>
<b>Aquamine™ PVC System</b>			
Series 2900	Aquamine™ PVC Pipe	110	<a href="#">50.01</a>
—	Aquamine™ Couplings	110	<a href="#">50.01</a>
Series 2970	Aquamine™ Coupling for Plain End PVC	111	<a href="#">50.01</a>
Series 2971	Aquamine™ Transition Coupling for PVC to HDPE	111	<a href="#">50.05</a>
Series 2972	Aquamine™ Transition Coupling for PVC to Groove	111	<a href="#">50.06</a>
—	Aquamine™ Fittings	112	<a href="#">50.01</a>
Series 2921	Aquamine™ Ball Valve	113	<a href="#">50.01</a>
Series 2950	Aquamine™ Butterfly Valve	113	<a href="#">50.01</a>
APG	Aquamine™ Grooving Tool	136	<a href="#">24.01</a>
<b>CPVC/PVC System</b>			
Style 357	Installation-Ready™ Rigid Coupling	116	<a href="#">33.07</a>
Style 356	Installation-Ready™ Transition Coupling	116	<a href="#">33.06</a>
Style 358	Reducing Coupling	116	<a href="#">33.08</a>
—	PGS-300 Grooved End Fittings	117	<a href="#">33.03</a>
Style 355	PGS-300 Grooved End Expansion Joint	118	<a href="#">33.05</a>
CG1100	PGS-300 Cut Grooving Tool for Plastic Pipe	135	<a href="#">24.09</a>
<b>Pipe Preparation Tools</b>			
<b>Roll Grooving Tools</b>			
VE12	Field Portable Roll Grooving Tool	121	<a href="#">24.01</a>
RG1200	OGS-200 Field Portable Roll Grooving Tool	121	<a href="#">24.11</a>
VE26	Field Portable Roll Grooving Tool	122	<a href="#">24.01</a>
VE46	Field Portable Roll Grooving Tool	122	<a href="#">24.01</a>
VE226	Field Portable Roll Grooving Tool	123	<a href="#">24.01</a>
RG3600	StrenqThin™ 100 Field Portable Roll Grooving Tool	123	<a href="#">24.08</a>
VE106/VE107	Field Fabrication Roll Grooving Tool	124	<a href="#">24.01</a>
VE206	Field Fabrication Roll Grooving Tool	124	<a href="#">24.01</a>
VE2725FS	Field Fabrication Roll Grooving Tool	125	<a href="#">24.01</a>
VE270FSD/ VE271FSD	Field Fabrication Roll Grooving Tool	125	<a href="#">24.01</a>
VE416FS	Field Fabrication Roll Grooving Tool	126	<a href="#">24.01</a>
VE416FSD/ VE417FSD	Field Fabrication Roll Grooving Tool	126	<a href="#">24.01</a>
VE450FSD	Field Fabrication Roll Grooving Tool	127	<a href="#">24.01</a>
RG3210	Field Fabrication Roll Grooving Tool	127	<a href="#">24.18</a>
VE268	Plant/Shop Fabrication Roll Grooving Tool	128	<a href="#">24.01</a>
VE414MC	Plant/Shop Fabrication Roll Grooving Tool	128	<a href="#">24.01</a>
50T	Plant/Shop Fabrication Roll Grooving Tool	129	<a href="#">24.03</a>
VE460	Plant/Shop Fabrication Roll Grooving Tool	130	<a href="#">24.03</a>
RG5200i	Plant/Shop Fabrication Roll Grooving Tool	131	<a href="#">24.05</a>
<b>Cut Grooving Tools</b>			
VG	Field Fabrication Cut Grooving Tool	131	<a href="#">24.01</a>
VG28GD	Field Fabrication Cut Grooving Tool	132	<a href="#">24.01</a>
VG28GD-ABR	Field Fabrication Cut Grooving Tool	132	<a href="#">24.01</a>
VDG26GD	Field Fabrication Cut Grooving Tool	132	<a href="#">24.01</a>
VG26GD-COR	Field Fabrication Cut Grooving Tool	132	<a href="#">24.01</a>
VG824	Field Fabrication Cut Grooving Tool	133	<a href="#">24.01</a>
VG824-ABR	Field Fabrication Cut Grooving Tool	133	<a href="#">24.01</a>

## Reference Guide

Model	Product Description	Pages	Publication
VG824DG	Field Fabrication Cut Grooving Tool	133	<a href="#">24.01</a>
VG824-COR	Field Fabrication Cut Grooving Tool	133	<a href="#">24.01</a>
VG828	Field Fabrication Cut Grooving Tool	134	<a href="#">24.01</a>
VG412	Field Fabrication Cut Grooving Tool	134	<a href="#">24.01</a>
CG1100	PGS-300 Cut Grooving Tool for Plastic Pipe	135	<a href="#">24.09</a>
VP824	Cut Grooving Tool for Plastic Pipe	135	<a href="#">24.01</a>
CG3100 CG3300 CG3500	Field Fabrication Cut Grooving Tool for HDPE Pipe	136	<a href="#">24.06</a>
<b>Other Pipe Preparation Tools</b>			
APG	Aquamine™ Grooving Tool	136	<a href="#">24.01</a>
HCT904	Hole Cutting Tool	137	<a href="#">24.01</a>
HCT908	Hole Cutting Tool	137	<a href="#">24.01</a>
VHCT900	Hole Cutting Tool	138	<a href="#">24.01</a>
VIC-TAP II	Hole Cutting Tool	138	<a href="#">24.01</a>
—	Style 926 Spigot Hole Cut Saw for HDPE Pipe	139	<a href="#">11.07</a>
PC3110	QuickVic™ SD Cut and Mark Tool	139	<a href="#">34.01</a>
VCT1	Manual Pipe Cut-Off Tool	140	<a href="#">24.01</a>
VCT2	Automatic Pipe Cut-Off Tool	140	<a href="#">24.01</a>
PFT510	Vic-Press™ Tool	141	<a href="#">24.01</a>
Power Mule II	Tool Accessories	141	<a href="#">24.01</a>
VAPS112	Adjustable Pipe Stand	142	<a href="#">24.01</a>
VAPS224	Adjustable Pipe Stand	142	<a href="#">24.01</a>
VAPS1672	Adjustable Pipe Stand	143	<a href="#">24.01</a>
VAPS270	Adjustable Pipe Stand	143	<a href="#">24.01</a>
—	Groove Diameter Cables	144	—
—	Pipe Measurement Tools	145	—
No. T-60	Test Cap Kit	146	<a href="#">24.07</a>
CTM-01	VBSP Small Manual Closure Tool	146	<a href="#">24.01</a>
CTM-02	VBSP Large Manual Closure Tool	146	<a href="#">24.01</a>
CTH-01	VBSP Small 10-Ton Hydraulic Closure Tool	146	<a href="#">24.01</a>
CTH-02	VBSP Large 25-Ton Hydraulic Closure Tool	146	<a href="#">24.01</a>
VAP131	Fabrication Cell	147	<a href="#">24.01</a>
VAPS 131R	Hydraulic Adjustable Pipe Stand for Fabrication Cell	147	<a href="#">24.01</a>
VAPS 131F	Hydraulic Positioner for Fabrication Cell	148	<a href="#">24.01</a>
VAPS 131T	Assembly Table for Fabrication Cell	148	<a href="#">24.01</a>

## Warranty

We warrant all products to be free from defects in materials and workmanship under normal conditions of use and service. Our obligation under this warranty is limited to repairing or replacing at our option at our factory any product which shall within one year after delivery to original buyer be returned with transportation charges prepaid, and which our examination shall show to our satisfaction to have been defective.

THIS WARRANTY IS MADE EXPRESSLY IN LIEU OF ANY OTHER WARRANTIES, EXPRESS OR IMPLIED, INCLUDING ANY IMPLIED WARRANTY OF MERCHANTABILITY OR FITNESS FOR A PARTICULAR PURPOSE. THE BUYER'S SOLE AND EXCLUSIVE REMEDY SHALL BE FOR THE REPAIR OR REPLACEMENT OF DEFECTIVE PRODUCTS AS PROVIDED HEREIN. THE BUYER AGREES THAT NO OTHER REMEDY (INCLUDING, BUT NOT LIMITED TO, INCIDENTAL OR CONSEQUENTIAL DAMAGES FOR LOST PROFITS, LOST SALES, INJURY TO PERSON OR PROPERTY OR ANY OTHER INCIDENTAL OR CONSEQUENTIAL LOSS) SHALL BE AVAILABLE TO HIM.

Victaulic neither assumes nor authorizes any person to assume for it any other liability in connection with the sale of such products.

**This warranty shall not apply to any product which has been subject to misuse, negligence or accident, which has been repaired or altered in any manner outside of a Victaulic factory or which has been used in a manner contrary to Victaulic instructions or recommendations. Victaulic shall not be responsible for design errors due to inaccurate or incomplete information supplied by Buyer or its representatives.**

Items purchased by Victaulic and resold will have the original equipment manufacturer's warranty extended to Victaulic customers.

## California Proposition 65

Victaulic has determined that a California law, commonly known as Proposition 65, requires the following warnings for products sold in, or into, California. All Victaulic® products meet or exceed the requirements of the applicable performance and safety standards, including (where applicable), the Safe Drinking Water Act and NSF-61.

### For all Victaulic painted ductile iron products:

	<b>WARNING:</b> The external painted surfaces of these products can expose you to trace amounts of chemicals, including BBP, which are known to the State of California to cause birth defects or other reproductive harm. For more information go to <a href="http://www.p65warnings.ca.gov">www.p65warnings.ca.gov</a> .
---	--

### For all Victaulic products ordered with specialty gaskets of Grades V and M2:

	<b>WARNING:</b> Grades V and M2 can expose you to trace amounts of chemicals, such as ethylene thiourea, which is known to the State of California to cause cancer and birth defects or other reproductive harm. For more information go to <a href="http://www.p65warnings.ca.gov">www.p65warnings.ca.gov</a> .
---	--

### For all Victaulic products made of or containing brass components:

	<b>WARNING:</b> Brass components, even those manufactured from "low lead" or "no lead" brass can expose you to trace amounts of chemicals, such as lead, which is known to the State of California to cause cancer and birth defects or other reproductive harm. For more information go to <a href="http://www.p65warnings.ca.gov">www.p65warnings.ca.gov</a> .
---	--

## Regulatory Compliance

Victaulic piping system products are tested and certified for a wide range of applications. Victaulic engages with many certifying authorities, approval bodies, and standards organizations globally, and maintains product certifications and strict compliance to applicable codes, standards, and directives, relevant to specific industries and markets.

## PRODUCT CERTIFICATIONS:

### Fire Protection

ACTIVFIRE – ActivFire Register of Fire Protection Equipment (Australia)

AON – AON New Zealand

CCCF – China Certification Center for Fire Protection Products (China)

CFPSC – Chinese Fire Protection Safety Center (Taiwan)

CNBOP – Centrum Naukowo-Badawcze Ochrony Przeciwpowarowej (Poland)

CNPP – Centre National de Prévention et de Protection (France)

CSFM – California State Fire Marshall (USA)

CTPC – Consiliul Technic Permanent Pentru Constructii (Romania)

EMI – Épitésügyi Minőségellenőrző Innovációs (Hungary)

FESC – Fire Equipment and Safety Center of Japan

FDNY – Fire Department, City of New York (USA)

FM – FM Approvals (USA)

HDB – Housing Development Board (Singapore)

KFI – Korea Fire Institute

KFSD – Kuwait Fire Service Directorate

LPCB – Loss Prevention Certification Board (UK)

SBSC – Svensk Brand- & Säkerhetscertifiering AB (Sweden)

TFRI – Tianjin Fire Research Institute of Ministry of Public Security (China)

TSU – Technický Skúšobný Ústav Piešťany, š.p. (Slovakia)

TZUS – Technický a Zkušební Ústav Stavební Praha, s.p. (Czech Republic)

UAE CD – United Arab Emirates Civil Defense

UKRFIRECERT – State Certification Center (Ukraine)

UL – Underwriter's Laboratories, LLC (USA)

ULC – Underwriter's Laboratories of Canada

VdS – Verband der Schadenverhütung GmbH (Germany)

VKF – Vereinigung Kantonaler Feuerversicherungen (Switzerland)

Zagrebinspekt (Croatia)

### Potable Water

ARPA – Agenzia Regionale per la Protezione dell'Ambiente (Italy)

Belgaqua – Belgische Federatie voor de Watersector (Belgium)

DVGW – Deutscher Verein des Gas- und Wasserfaches e.V. (Germany)

Eurofins – ACS : Attestation de Conformité Sanitaire (France)

HZJZ – Hrvatski zavod za javno zdravstvo (Croatia)

INSP – Institutul Național De Sănătate Publică (Romania)

KWWA – Korea Water and Wastewater Works Association

NSF – NSF International (USA)

ÖVGW – Österreichische Vereinigung für das Gas- und Wasserfach (Austria)

PZH – Państwowy Zakład Higieny (Poland)

RUVZPP – Regionálny úrad verejného zdravotníctva so sídlom v Poprad (Slovakia)

SAI Global – WaterMark (Australia)

SPAN – Suruhanjaya Perkhidmatan Air Negara (Malaysia)

SVGW – Schweizerischer Verein des Gas- und Wasserfaches (Switzerland)

UL – Underwriter's Laboratories, LLC – NSF 61/372 (USA)

WRAS – Water Regulations Advisory Scheme (UK)

ZUOVA – Zdravotní ústav se sídlem v Ostravě (Czech Republic)

### Maritime

ABS – American Bureau of Shipping

BV – Bureau Veritas (France)

CCG – Canadian Coast Guard (Canada)

CRS – Croatian Register of Shipping (Croatia)

CCS – China Classification Society (China)

DNV GL – Det Norske Veritas-Germanischer Lloyd (Norway)

KRS – Korean Register of Shipping (Korea)

LR – Lloyd's Register of Shipping (UK)

RINA – Registro Italiano Navale (Italy)

USCG – US Coast Guard (USA)

### HVAC

CSTB – Centre Scientifique et Technique du Bâtiment (France)

ITB – Instytut Techniki Budowlanej (Poland)

Sercons Europe BV (Russia)

### Plumbing

IAPMO – International Association of Plumbing & Mechanical Officials (USA)

NSF – NSF International (USA)

## COMPLIANCE:

### Codes and Standards Compliance

ANSI – American National Standards Institute

API – American Petroleum Institute

APSAD – Assemblée Plénière Société Assurance Dommage (France)

AS/NZS – Standards Australia and Standards New Zealand (AU & NZ)

ASME – American Society of Mechanical Engineers (USA)

ASTM International (USA)

AWWA – American Water Works Association

CSA – CSA Group (Canada)

GOST R – Gosstandart (Russia)

IBC – International Building Code (USA)

ICC – International Code Council (USA)

IMC – International Mechanical Code (USA)

IPC – International Plumbing Code (USA)

IRC – International Residential Code (USA)

ISO – International Organization for Standardization (Global)

MSS – Manufacturer's Standardization Society (USA)

NACE – National Association of Corrosion Engineers (USA)

NFPA – National Fire Protection Association (USA)

UPC – Uniform Plumbing Code (USA)

WSAA – Water Services Association of Australia

### Pressure Equipment Safety

(2014/68/EU) PED – Pressure Equipment Directive (Europe)

CSA B51 – "Boiler, Pressure Vessel, and Pressure Piping Code" (Canada)

CRN – Canadian Registration Numbers per CSA B51

CU TR 032/2013 – Customs Union Technical Regulation "On Safety of Pressurized Equipment" (EAC)

### Chemical Safety / Recycling

BVB – Byggvarubedomningen Service AB (Sweden)

(EC/1907/2006) REACH – Registration, Evaluation, Authorization, and Restriction of Chemicals (Europe)

(2011/65/EU) RoHS2 – Restriction of Hazardous Substances Directive (Europe)

(2012/19/EU) WEEE – Waste Electrical and Electronic Equipment Directive (Europe)

SundaHus – SundaHus i Linköping (Sweden)

### Building Services

(EU/305/2011) CPR – Construction Products Regulation (Europe)

NBC – National Building Code (Canada)

### Explosive Environments

(2014/34/EU) ATEX – Equipment and protective systems for potentially explosive atmospheres (Europe)

### Seismic

OSHPD – Office of Statewide Health Planning and Development (USA)

PSB – TÜV SÜD PSB (Singapore)

### Tools and Machinery Safety

(2006/42/EC) MD – Machinery Directive (Europe)

(2014/35/EU) LVD – Low Voltage Directive (Europe)

(2014/30/EU) EMC – Electromagnetic Compatibility Directive (Europe)

© Copyright 2019, Victaulic® Company. All rights reserved.

No part of this Victaulic catalog may be reproduced, stored in a retrieval system, or transmitted, in any form or by any means, electronic, mechanical, photocopy, recording or otherwise, without the prior written permission of Victaulic Company.

# ENGINEERING CONFIDENCE INTO EVERY BUILD

Since 1919, Victaulic's innovative solutions and design services continue to increase construction productivity and reduce risk, ensuring projects are completed safely, on time and within budget. With more than 4,000 employees and 55 international facilities, Victaulic helps customers in 120 countries succeed in the global construction industry. Learn more about how our solutions engineer confidence into every build at [victaulic.com](http://victaulic.com).



## U.S./World Headquarters

4901 Kesslersville Road  
Easton, PA 18040 USA

[victauliclocations.com](http://victauliclocations.com)

## EMEA

Prijkelstraat 36  
9810 Nazareth, Belgium

## Asia Pacific

Unit 808, Building B  
Hongwell International Plaza  
No.1602 West Zhongshan Road  
Shanghai, China 200235



G-103 10576 REV D 03/2019

*Victaulic* and all other Victaulic marks are the trademarks or registered trademarks of Victaulic Company, and/or its affiliated entities, in the U.S. and/or other countries. All other trademarks listed herein are the property of their respective holders, in the U.S. and/or other countries. The terms "Patented" or "Patent Pending" refer to design or utility patents or patent applications for articles and/or methods of use in the United States and/or other countries.

© 2019 VICTAULIC COMPANY. ALL RIGHTS RESERVED.

